

38° 55' 00"

Latitude 38 55

Longitude 80 57 30"

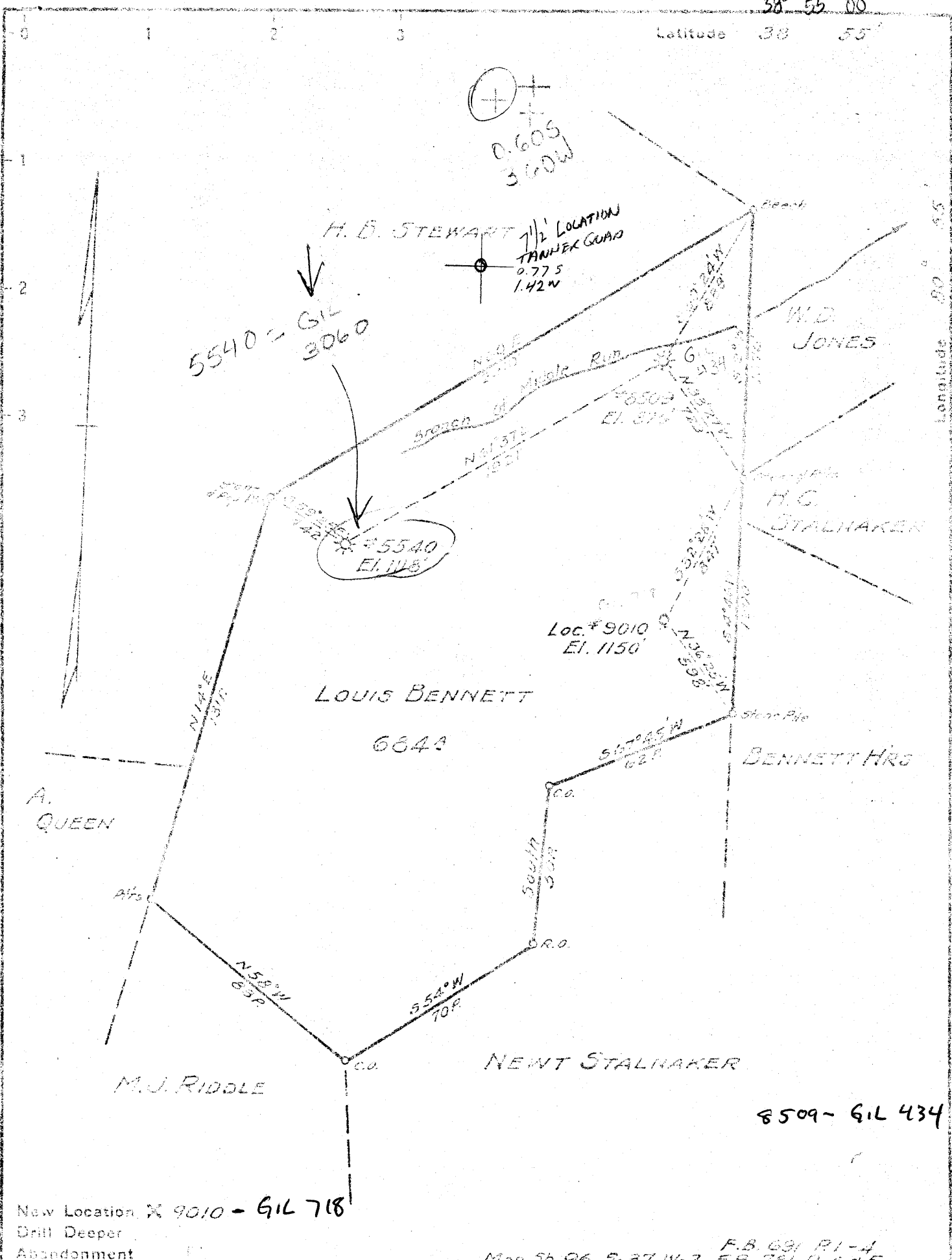

New Location X 9010 - GIL 718  
 Drill Deeper   
 Abandonment

Map Sh. 96 S-37 W-2 F.B. 691 P1-4  
 F.B. 781 P 445

Company HOPE NATURAL GAS CO.  
 Address CLARKSBURG, W. VA.  
 Farm LOUIS BENNETT  
 Tract \_\_\_\_\_ Acres 684 Lease No. 25041  
 Well (Farm) No. \_\_\_\_\_ Serial No. As Shown  
 Elevation (Spot Level) As Shown  
 Quadrangle GREENVILLE 710  
 County GILMER District DEKALO  
 Engineer W. M. [Signature]  
 Engineer's Registration No. 900  
 File No. \_\_\_\_\_ Drawing No. \_\_\_\_\_  
 Date 11-7-15 Scale 1" = 400'

STATE OF WEST VIRGINIA  
 DEPARTMENT OF MINES  
 OIL AND GAS DIVISION  
 CHARLESTON

WELL LOCATION MAP  
 FILE NO. GIL 3060 - 5540  
(430, 718)

+ Denotes location of well on United States Topographic Maps, scale 1 to 62,500, latitude and longitude lines being represented by border lines as shown.

- Denotes one inch spaces on border line of original tracing.

Located on LOUIS BARNETT FARM  
 District Center County Gilmer State W. Va.

Location Made 6-9-19 First Work Done 8-20-19  
 Rig Commenced 9-12-19 Rig Completed 9-20-19  
 Drilling Commenced 1-10-20 Drilling Completed 4-1-20  
 Rig Contractor H. N. G. Co. { Drilling Contractor } H. N. G. Co. String #352  
 { H. N. G. Co. Tools, String No. }  
 Drillers W. H. Eisman and Ben Overton  
 Tool Dressers Cecil Boone and Brad Gainer

FORMATION	Open or Close Hard or Soft	TOP	BOTTOM	Steel Line Measurements	Water Found Depth	OU Found Depth	Gas Found Depth	REMARKS
Native Coal		440	445					
Coal								
Pittsburgh Coal								
Little Dunkard		890	915					
Big Dunkard		1005	1125		1085			2 B. an hour
Gas Sand		1130	1218					
First Salt		1240	1275					
Sand		1292	1307					
Second Salt		1544	1580					
3d. Salt		1715	1745					
Maxon		1820	1862		1845			Salt Water
Little Lime		1886	1912					
Pencil Cave		1912	1940	1935			1935	4/10 water 1"
Big Lime		1940	2005				1947	
Big Injun		2005	2095	2002			2002	more at 2005
Squaw				2080			2080	19/10 water 2"
Berea							2087	
Gantz								
Fifty Feet								
Thirty Feet								
Gordon Stray								
Gordon								
Fourth								
Fifth								
Rayard								
Total Depth			2107					

SIZE	Charged to Well		Put in Well		Pulled Out		Left in Well		Transferred Before Completing		Left at Well Not in Use		If more than two strings of casing are left in hole, give reasons for leaving additional strings
	Feet	In.	Feet	In.	Feet	In.	Feet	In.	Feet	In.	Feet	In.	
13" Csg.			12										
10" "	183	5	144				144				39	5	
8 1/2" "	1139	2	1010	8			1013	2			126		
6 1/2" "	56	9									56	9	
5 1/2" "	2498	1	1930	2			1937	4			560	9	
Tbg.													

PACKER RECORD

SIZE	KIND	Amount Anchor	Amount Above Anchor	REMARKS
8 1/2"	Steel Shoe on bottom of 8 1/2" casing			
6 1/2" x 8 1/2"	Anchor packer	1461	1926	
1"	5/8" Shoe - 2 6/8" x 5/8" Swg. Nipples			

SHOOTING RECORD (If shot before or upon completion of well)

021-3060

DATE	Quarts	Top of Shell	Bottom of Shell	Diameter	Sand	TEST BEFORE SHOT			TEST AFTER SHOT			Tool Taken After Shot Sp. Hours	By Whom Shot
						Reading	Liquid	Opening	Reading	Liquid	Opening		
4-25-20	20	2079	2087	4	Injun	16/10	Mer.	2	34/10	W.	5 1/2	24	Mar. Tor. Co.

CEMENTING RECORD

Date Cemented Not cemented Size Hole Cemented..... Size Casing Cemented.....  
 Top Pittsburgh Coal..... Top Cementing..... Amount Cement Used.....  
 Bottom Pittsburgh Coal..... Bottom Cementing..... Amount Sand Used.....  
 Mr. .... of ..... Coal Company on ground when coal was cemented  
 Remarks: ..... Signature of persons who cemented well

Approved by J.W. TAYLOR  
 Foreman