

Latitude 38° 55'

Longitude 80° 55'

5.16 S
0.33 W

5.20 S
0.34 W

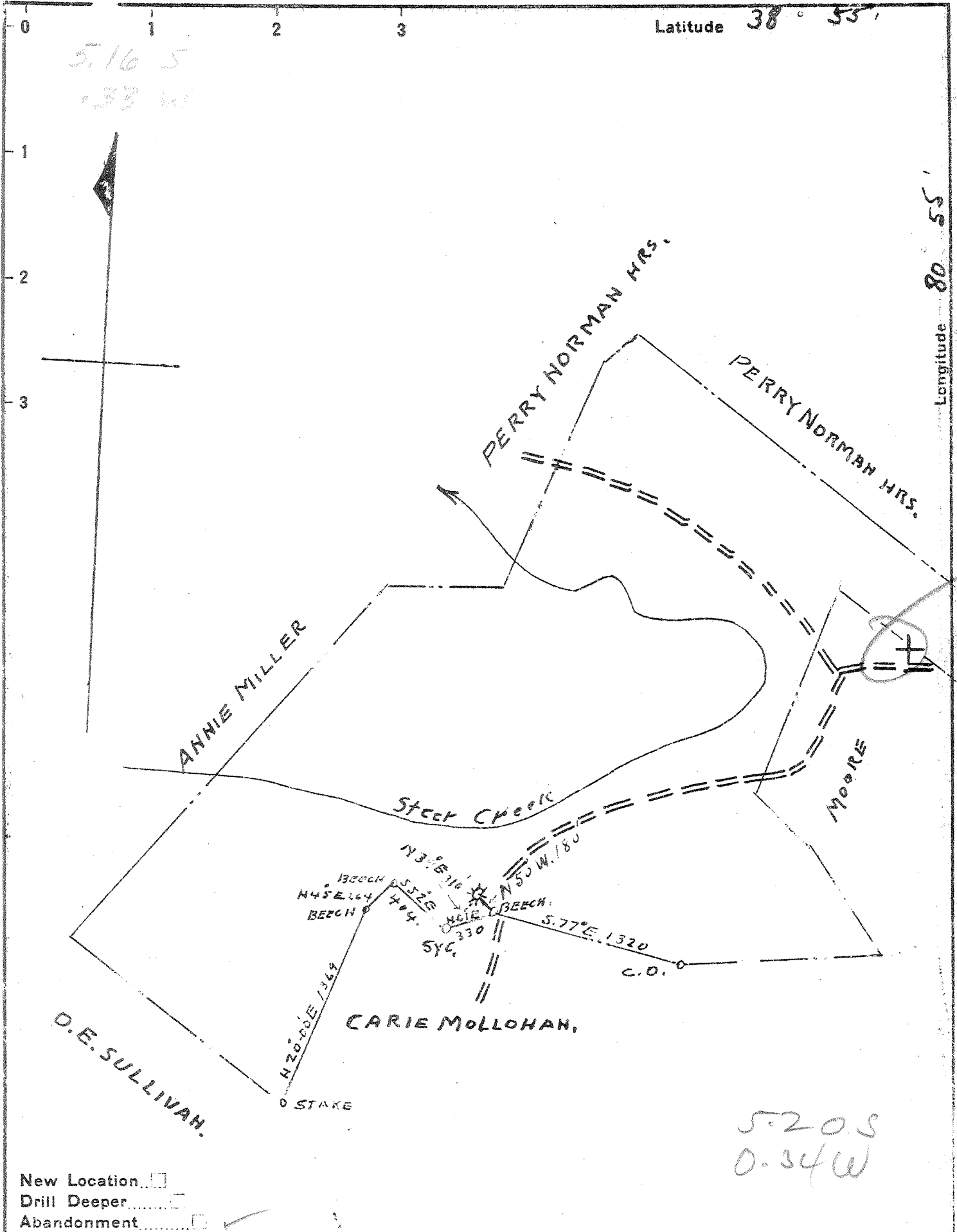

New Location

Drill Deeper

Abandonment

Company STEER CREEK OIL & GAS CO.

Address 918 BIGLEY AVE. CHARLESTON, W.V.A.

Farm C. D. Mollohan

Tract _____ Acres 180 Lease No. _____

Well (~~Farm~~) No. 5 Serial No. _____

Elevation (Spirit Level) 750.00

Quadrangle Glenville

County Gilmer District CENTER

Engineer J. Moore

Engineer's Registration No. 159

File No. _____ Drawing No. _____

Date NOV. 5, 1942 Scale 1" = 800'

STATE OF WEST VIRGINIA
DEPARTMENT OF MINES
OIL AND GAS DIVISION
CHARLESTON

WELL LOCATION MAP
FILE NO. GIL-187-A

+ Denotes location of well on United States Topographic Maps, scale 1 to 62,500, latitude and longitude lines being represented by border lines as shown.

- Denotes one inch spaces on border line of original tracing.