

Latitude 39° 05'

Scale 1" = 800 Feet

80° 17' 50"

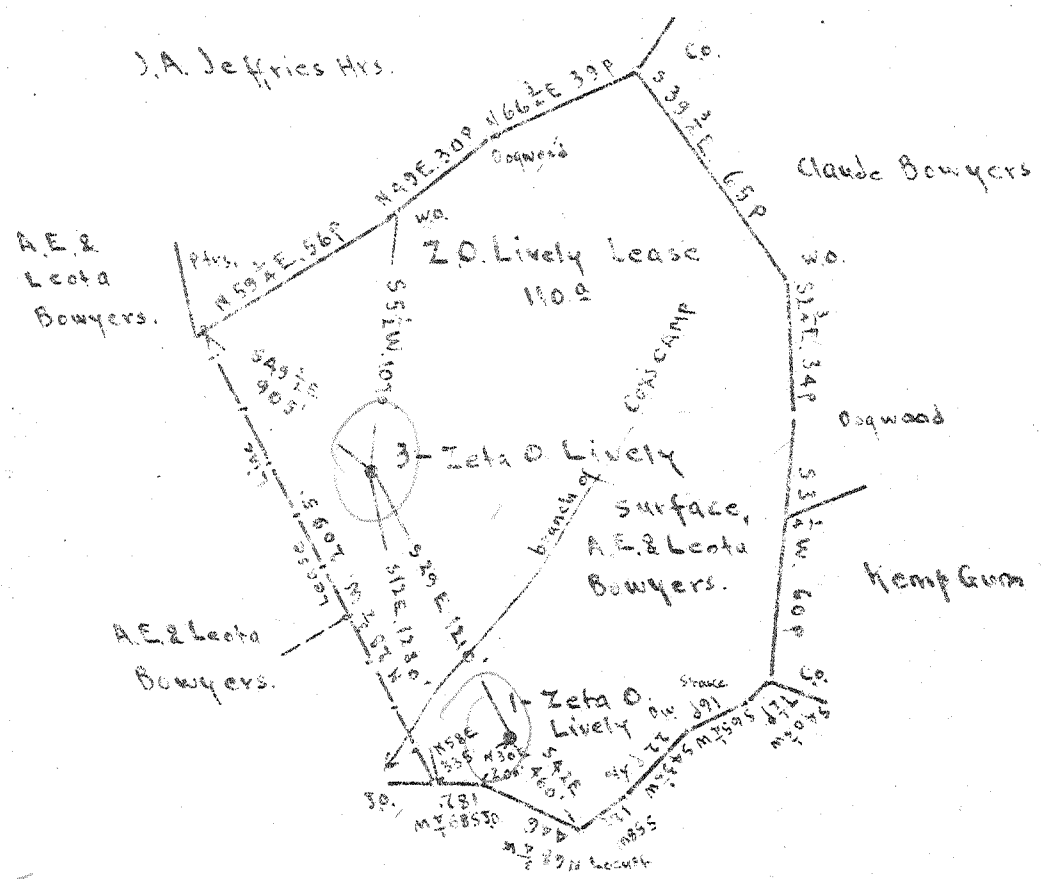

#1 1.83 S  
 .106 W

---

#3 1.65 S  
 .20 W

Claude Bowyers.

Surface: A.E. & Leota Bowyers.

Address: A.E. Bowyers, Coals Mills, Gilmer Co. W.Va.

There is no Commercial Coal.

New Location   
 Drill Deeper   
 Abandonment

Map 16

S 27 W 13

Company The Tri-State Pipe Co.  
 Address Bellaire Ohio  
 Farm Z O Lively  
 Tract \_\_\_\_\_ Acres 110 Lease No. \_\_\_\_\_  
 Well (Farm) No. 1 and 3 Serial No. \_\_\_\_\_  
 Elevation (Spirit Level) 3 - Floor 1076.8, Ground 1074.09  
 Quadrangle HOLBROOK  
 County Gilmer District Troy  
 Engineer E C Tobler  
 Engineer's Registration No. \_\_\_\_\_  
 File No. \_\_\_\_\_ Drawing No. \_\_\_\_\_  
 Date May 13<sup>th</sup> 1948 Scale 1" = 800 Feet

STATE OF WEST VIRGINIA  
 DEPARTMENT OF MINES  
 OIL AND GAS DIVISION  
 CHARLESTON

WELL LOCATION MAP  
 FILE NO. GIL-264-A-#1  
GIL-265-A-#3

+ Denotes location of well on United States Topographic Maps, scale 1 to 62,500, latitude and longitude lines being represented by border lines as shown.  
 - Denotes one inch spaces on border line of original tracing.

ZETA O. LIVELY NO. 1 WELL.

Troy District, Gilmer County, W. Va.  
 By The Tri-State Pipe Co., Bellaire, Ohio.  
 Abandoned under permit Gil-264-A.  
 On 110 acres.  
 Elevation, 979.96' L.  
 Surface owned by A. E. and Leota Bowyers, Coxs Mills, W. Va.  
 Drilling completed June 12, 1919.  
 No record of any shot.  
 8 1/2" casing, 946'; 6 5/8", 1830'; 2" tubing, 2280'.  
 B. H. packer, 8 1/2 x 6 5/8, set at 946'.  
 Oil well. Record to Dept. of Mines stamped July 2, 1948.  
 Record to RCT from Mrs. Griffith Sept. 3, 1948. Old File No. 409.

	Top.	Bottom.
(water, 140', 2 bailers per hour)		
Little Dunkard Sand	720	- 748
Big Dunkard Sand	780	- 815
Gas Sand	940	- 1048
Sand	1100	- 1142
1st Salt Sand	1242	- 1275
2nd Salt Sand	1452	- 1505
3rd Salt Sand (water, 1604', 4 bailers per hour)	1580	- 1650
Maxton Sand (water, 1700', 1 bailer per hour)	1690	- 1708
Little Lime	1763	- 1790
Blue Monday Sand	1790	- 1800
Pencil Cave	1800	- 1804
Big Lime	1804	- 1867
Big Injun Sand (gas, 1882')	1867	- 1966
Squaw Sand (oil, 2067')	2050	- 2189
Berea Sand (water, 2212'; oil, 2212') ///	2250	- 2286
Total depth		2286



STATE OF WEST VIRGINIA  
DEPARTMENT OF MINES  
OIL AND GAS DIVISION

409

WELL RECORD

Permit No. 304-A Oil or Gas Well X (KIND)

Company The Tri-State Pipe Co.  
Address Bellaire, O.  
Farm Zeta O. Lively Acres 110  
Location (waters) \_\_\_\_\_  
Well No. 1 Elev. 979.96  
District Troy County Gilmer  
The surface of tract is owned in fee by A. E. & Leota  
Bowyers Address Cox's Mills, W. Va.  
Mineral rights are owned by (Gilmer Co.)  
Address \_\_\_\_\_

Casing and Tubing	Used in Drilling	Left in Well	Packers
Size			Kind of Packer
16			<u>B.H. Packer</u>
13			Size of
10			<u>8 1/4" - 946'</u>
8 1/4	<u>946'</u>		Depth set <u>8 1/4" x 6-5/8</u>
6 5/8	<u>1830'</u>		
5 3/16			Perf. top
3			Perf. bottom
2	<u>2280'</u>		Perf. top
Liners Used			Perf. bottom

Drilling commenced \_\_\_\_\_  
Drilling completed June 12, 1919  
Date Shot No record of any shot.  
With \_\_\_\_\_  
Open Flow /10ths Water in \_\_\_\_\_ Inch  
/10ths Merc. in \_\_\_\_\_ Inch  
Volume \_\_\_\_\_ Cu. Ft.  
Rock Pressure \_\_\_\_\_ lbs. \_\_\_\_\_ hrs.  
Oil \_\_\_\_\_ bbls., 1st 24 hrs.  
Fresh water \_\_\_\_\_ feet \_\_\_\_\_ feet  
Salt water \_\_\_\_\_ feet \_\_\_\_\_ feet

CASING CEMENTED \_\_\_\_\_ SIZE \_\_\_\_\_ No. Ft. \_\_\_\_\_ Date \_\_\_\_\_  
COAL WAS ENCOUNTERED AT \_\_\_\_\_ FEET \_\_\_\_\_ INCHES  
\_\_\_\_\_ FEET \_\_\_\_\_ INCHES \_\_\_\_\_ FEET \_\_\_\_\_ INCHES  
\_\_\_\_\_ FEET \_\_\_\_\_ INCHES \_\_\_\_\_ FEET \_\_\_\_\_ INCHES

Formation	Color	Hard or Soft	Top	Bottom	Oil, Gas or Water	Depth Found	Remarks
Water			140	(2 Bailers per hr.)			
Little Dunkard			720	748			
Big Dunkard			780	815			
Gas Sand			940	1048			
Sand			1100	1142			
1st Salt			1242	1275			
2nd Salt			1452	1505			
3d Salt			1580	1650			
Water			1604	(4 Bailers per hr.)			
Maxon			1690	1708			
Water			1700	(1 Bailer " "			
Little Lime			1763	1790			
Blue Monday			1790	1800			
Pencil Cave			1800	1804			
Big Lime			1804	1867			
Big Injun			1867	1966			
Gas			1882				
Squaw			2050	2189			
Oil			2067				
Berea			2250	2286			
Water			2212				
Oil			2212				
Total depth				2286			

