

**Antero Resources
Well No. Ford Unit 1H
As-Drilled Plat
Antero Resources
Corporation**

7,114' to Bottom Hole
5,438' to Top Hole
TOP & BOTTOM HOLE LATITUDE 39 - 17 - 30

Notes:
West Virginia Coordinate System of 1927, North Zone based upon Differential GPS Measurements.
Well No. Ford Unit 1H Top Hole coordinates are
N: 276,163.54' Latitude: 39°15'12.12"
E: 1,699,744.00' Longitude: 80°33'37.08"
Bottom Hole coordinates are
N: 285,882.84' Latitude: 39°16'47.99"
E: 1,698,068.27' Longitude: 80°33'59.85"
UTM Zone 17, NAD 1983
Top Hole Coordinates Bottom Hole Coordinates
N: 4,344,995.601m N: 4,347,948.109m
E: 537,953.880m E: 537,394.041m
Plat orientation and corner and well references are based upon the grid north meridian.
Well location references are based upon the magnetic meridian.

Top Hole coordinates verified by survey grade GPS. As-drilled data and information was provided by Antero Resources Corporation. Allegheny Surveys, Inc. (ASI) is not certifying the data and information provided. ASI is not responsible for any errors or inaccuracies with the data and information that has been provided.

Tax Map 301 Parcels

Par	Owner	DB/Pg	Acres
23	80.1 William & Barbara McClain	1180/728	12.62
24	79.5 Christopher L. Snyder	1332/65	20.35
25	80 Gary L. & Katrina Sutton	1161/977	6.70
26	67.1 Leroy E. & Sonia Key	1259/820	0.04
27	79 Carolyn N. Plaugher	F111/1050	10.62
28	80.2 John Jr. & Linda K. Marks	1243/881	19.06
29	80.3 William & Barbara McClain	1154/342	0.98
30	79.4 Kenneth Lockhart, et ux	1446/127	0.63
31	79.3 Kenneth Lockhart, et ux	1446/127	1.88
32	79.1 Lonnie Dale & Sharrell Dunn	1160/229	4.10
33	38 Patricia & Christopher Alan Ford	1386/410	12.5
34	39.2 Linda M. Fluharty	1171/231	55.76

Tax Map 321 Parcels

Par	Owner	DB/Pg	Acres
1	26 Christine R. Utter	1314/417	19.75
2	37 Hubert Jr. & Lorena Bland	1307/1209	28.50
3	31.1 Paul J. Ball	1354/948	4.87
4	15 Arthur & Linda Lunsford	1004/1154	18.41
5	35 Tillman Lee Williams	1322/1054	9.35
6	6.2 John D. & Theresa Ritter	1362/590	3.00
7	25 Tillman Lee Williams	1322/1054	8.17
8	28.2 Loren Brad Strother	1296/353	1.39
9	28.3 Nancy E. Farr	1362/580	1.99
10	28.4 Nancy E. Farr	1439/36	0.18
11	18.1 Minnie Davis	1291/761	1.66
12	27 City of Salem	642/123	1.50
13	28.1 Patricia A. Collins	1060/1140	1.46
14	37.1 Roberta G. Zwiebel	F104/780	0.98
15	38 Robert & Shirley Bowen	941/478	0.78
16	38.2 John & Marianne Clevenger	1247/289	1.05
17	6.1 Mark A./Gayle E. Sprouse	1244/264	0.29
18	18.3 Sharon D. Emerson	1424/1174	1.03
19	5 Ed & Sharon Jo Morgan	1385/95	37.13
20	16 Cathy Irene Moore	WB172/923	15.07
21	18 Cathy Irene Moore	WB172/923	39.84
22	5.6 Arthur & Linda Lunsford	1219/947	5.13

Bearing	Dist.
L1	S 32°10' W 2306.4'
L2	S 25°04' E 1265.2'
L3	S 17°25' E 1728.1'
L4	S 76°47' E 1021.0



- Legend**
- ⊙ Proposed gas well
 - ⊕ Found corner, as noted
 - - - Creek or Drain
 - - - Existing Road
 - Surface boundary (approx.)
 - - - Interior surface tracts (approx.)

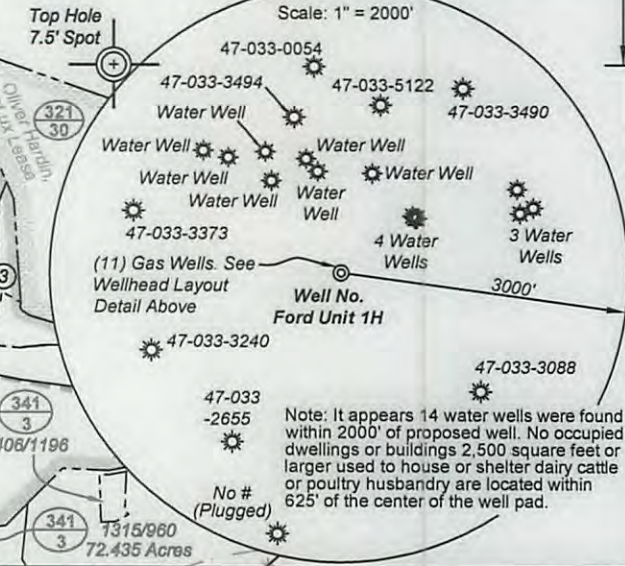

FILE NO: 11-36-TM-12
DRAWING NO: 11-12 Drilled Ford 1H Plat
SCALE: 1" = 1200'
MINIMUM DEGREE OF ACCURACY: Submeter
PROVEN SOURCE OF ELEVATION: WVDOT, Bridgeport, WV

STATE OF WEST VIRGINIA
DEPARTMENT OF ENVIRONMENTAL PROTECTION
OIL AND GAS DIVISION

DATE: November 3 20 14
OPERATOR'S WELL NO. Ford Unit 1H
API WELL NO
47 - 033 - 05702
STATE COUNTY PERMIT

WELL TYPE: OIL GAS LIQUID INJECTION WASTE DISPOSAL
(IF GAS) PRODUCTION: STORAGE DEEP SHALLOW
LOCATION: ELEVATION: 1376' WATERSHED: Patterson Fork QUADRANGLE: Salem
DISTRICT: Tenmile COUNTY: Harrison
SURFACE OWNER: Hubert Jr. & Lorena Bland ACREAGE: 28.56
ROYALTY OWNER: DEPI, et al; Tetrick Group II Revocable Trust; J. Moses Raad, et al LEASE NO: DV019191; 21030 ACREAGE: 283; 447; 40
PROPOSED WORK: DRILL CONVERT DRILL DEEPER FRACTURE OR STIMULATE PLUG OFF OLD FORMATION
 PERFORATE NEW FORMATION OTHER PHYSICAL CHANGE IN WELL (SPECIFY) As-Drilled
 PLUG AND ABANDON CLEAN OUT AND REPLUG TARGET FORMATION: Marcellus Shale DEPTH: 16,966' MD

WELL OPERATOR: Antero Resources Corporation DESIGNATED AGENT: Dianna Stamper - CT Corporation System
ADDRESS: 1615 Wynkoop Street ADDRESS: 5400 D Big Tyler Road
Denver, CO 80202 Charleston, WV 25313

11/28/2014