

1,659' to Bottom Hole

1,579' to Top Hole

LATITUDE 39 - 17 - 30

LONGITUDE 80 - 32 - 30

13,500' to Top Hole

13,454' to Bottom Hole

**Antero Resources**  
**Well No. Plaughter 2H**  
As-Drilled  
**Antero Resources Corporation**



Top Hole coordinates verified by survey grade GPS. As-drilled data and information was provided by Antero Resources Corporation. Allegheny Surveys, Inc. (ASI) is not certifying the data and information provided. ASI is not responsible for any errors or inaccuracies with the data and information that has been provided.

**Notes:**  
**West Virginia Coordinate System of 1927, North Zone based upon Differential GPS Measurements.**  
Well No. Plaughter Unit 2H Top Hole coordinates are  
N: 276,569.41 Latitude: 39°15'16.56"  
E: 1,703,446.70 Longitude: 80°32'50.07"

Bottom Hole coordinates are  
N: 276,616.22 Latitude: 39°15'17.02"  
E: 1,703,367.48 Longitude: 80°32'51.09"  
**UTM Zone 17, NAD 1983**

Top Hole Coordinates: N: 4,345,138.072m E: 539,079.874m  
Bottom Hole Coordinates: N: 4,345,151.930m E: 539,055.502m

Plat orientation and corner and well references are based upon the grid north meridian.  
Well location references are based upon the magnetic meridian.

**Wellhead Layout**  
Varnar Unit 2H (47-033-5738)  
Detail Not to Scale  
Gideon Unit 2H (47-033-5721)  
Gideon Unit 1H (47-033-5722)  
Plaughter Unit 2H (47-033-5795)  
Plaughter Unit 1H (47-033-5794)  
Lowndes Unit 2H (47-033-5719)  
Lowndes Unit 1H (47-033-5720)  
S 57°34' W  
10.0'

**Legend**

- ⊙ Proposed gas well
- ⊗ Found corner, as noted
- ⊙ Existing Well, as noted
- ⊙ Digitized Well
- Existing Road
- Surface boundary (approx.)
- - - Interior surface tracts (approx.)

321  
30  
Anthony E. Feathers  
1453/1121  
52.50 Acres

322  
14  
Charles F. & Rebecca Chong  
1245/795  
156 Acres

322  
18  
James A. Varnar  
1261/953  
65.45 Acres

322  
20  
James A. Varnar  
1199/860  
16.63 Acres

322  
23 14  
Ross Allen Jr. & Brenda L. White  
1385/234  
36.18 Acres

322  
19  
David B. Taylor  
1301/1069  
14 Acres

Note: 10 water wells were found within 2000' of proposed well. No occupied dwellings or buildings 2,500 square feet or larger used to house or shelter dairy cattle or poultry husbandry are located within 625' of the center of the well pad.

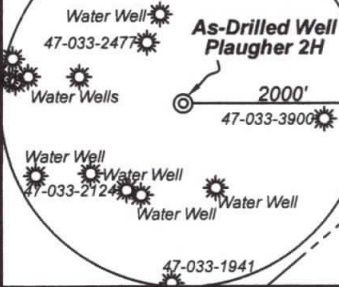

I, the undersigned, hereby certify that this plat is correct to the best of my knowledge and belief and shows all the information required by law and the rules issued and prescribed by the Department of Environmental Protection.

*Bradley D. Miller*  
Bradley D. Miller, P.S. 2167

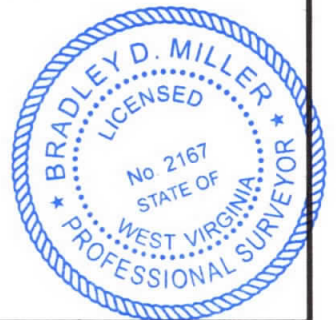

FILE NO: 13-36-TM-12  
DRAWING NO: Plaughter 2H As-Drilled  
SCALE: 1" = 500'  
MINIMUM DEGREE OF ACCURACY: Submeter  
PROVEN SOURCE OF ELEVATION: WVDOT, Bridgeport, WV

**STATE OF WEST VIRGINIA**  
DEPARTMENT OF ENVIRONMENTAL PROTECTION  
**OIL AND GAS DIVISION**

DATE: June 3 2020  
OPERATOR'S WELL NO. Plaughter 2H  
API WELL NO  
47 - 033 - 5795  
STATE COUNTY PERMIT

WELL TYPE:  OIL  GAS  LIQUID INJECTION  WASTE DISPOSAL  
(IF GAS) PRODUCTION:  STORAGE  DEEP  SHALLOW

LOCATION: ELEVATION: As-Built 1,456' WATERSHED: Tenmile Creek QUADRANGLE: Salem

DISTRICT: Tenmile COUNTY: Harrison

SURFACE OWNER: James A. Varnar ACREAGE: 65.45

ROYALTY OWNER: James A. Varnar Sr. LEASE NO: ACREAGE: 69.394

PROPOSED WORK:  DRILL  CONVERT  DRILL DEEPER  FRACTURE OR STIMULATE  PLUG OFF OLD FORMATION  
 PERFORATE NEW FORMATION  OTHER PHYSICAL CHANGE IN WELL (SPECIFY) As-Drilled

PLUG AND ABANDON  CLEAN OUT AND REPLUG TARGET FORMATION: Marcellus Shale ESTIMATED DEPTH: 2,507' TVD 2,513' MD

WELL OPERATOR: Antero Resources Corporation DESIGNATED AGENT: Dianna Stamper - CT Corporation System

ADDRESS: 1615 Wynkoop Street ADDRESS: 5400 D Big Tyler Road  
Denver, CO 80202 Charleston, WV 25313