

Latitude 38 10

Longitude 81 25

Williams Coal Company
12000 ac

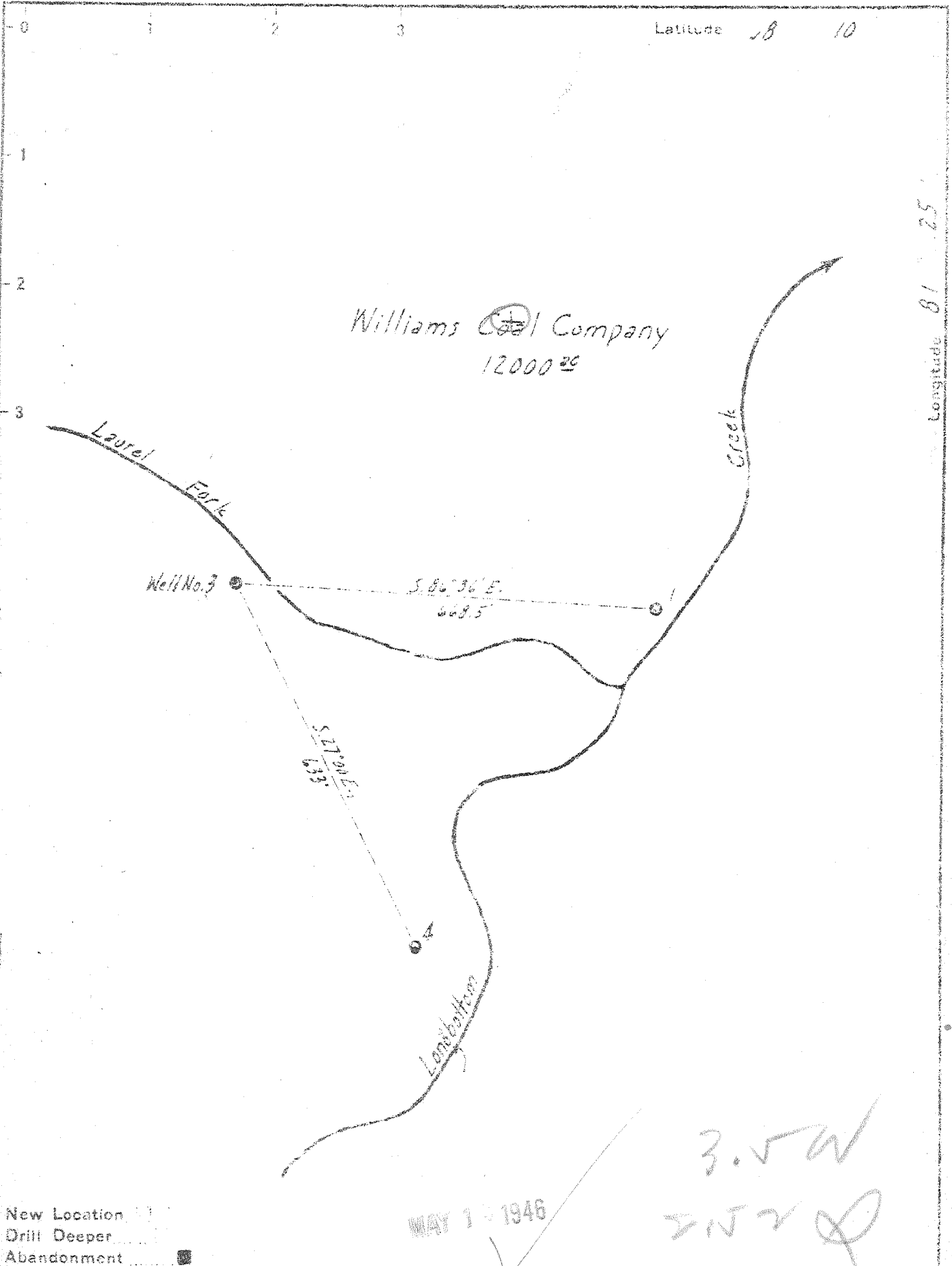

New Location

Drill Deeper

Abandonment

MAY 1 1946

3.5 W
S. V. 2 Q

Company The Pure Oil Company

Address Newark, Ohio

Farm Williams Coal Company

Tract Acres 12000 Lease No. 5012

Well (Farm) No. 3 Serial No. 206

Elevation (Spirit Level) 885'

Quadrangle Montgomery

County Kanawha District Cabin Creek

Engineer J. B. Hunter

Engineer's Registration No. Ohio-2912

Title No. _____ Drawing No. _____

Date April 3, 1946 Scale 1" = 200'

STATE OF WEST VIRGINIA
DEPARTMENT OF MINES
OIL AND GAS DIVISION
CHARLESTON

WELL LOCATION MAP
FILE NO. KAN-444-A

+ Denotes location of well on United States Topographic Maps, scale 1 to 62,500, latitude and longitude lines being represented by border lines as shown.

- Denotes one inch spaces on border line of original tracing.

WILLIAMS COAL CO. NO. 3 — PURE OIL CO.

KAN-444-A



STATE OF WEST VIRGINIA
DEPARTMENT OF MINES
OIL AND GAS DIVISION

1154

WELL RECORD

Permit No. 444-A Oil or Gas Well (KIND)

Company The Pure Oil Company
Address Box 551 - Newark, Ohio
Farm Williams Coal Company Acres 12,000
Location (waters) Cabin Creek
Well No. 5 Elev. 885'
District Cabin Creek County Kanawha
The surface of tract is owned in fee by Shenk Land Company
D. C. Shenk Address Dawes, W. Va.
Mineral rights are owned by Shenk Land Company
D. C. Shenk Address Dawes, W. Va.
Drilling commenced January 25, 1915
Drilling completed April 17, 1915
Date Shot 4-20-15 From 2515' To 2537'
With 60 quarts

Casing and Tubing	Used in Drilling	Left in Well	Packers
Size			Kind of Packer
16			
13			
10	240'	Pulled	Size of
8 1/4	1367'	804'	
6 1/2	1359'	1359'	Depth set
5 3/16			
3			Perf. top
2			Perf. bottom
Liners Used			Perf. top
			Perf. bottom

Open Flow /10ths Water in _____ Inch
/10ths Merc. in _____ Inch
Volume _____ Cu. Ft.
Rock Pressure _____ lbs. _____ hrs.
Oil 10 _____ bbls., 1st 24 hrs.
Fresh water _____ feet _____ feet
Salt water _____ feet _____ feet

CASING CEMENTED _____ SIZE _____ No. Ft. _____ Date _____
COAL WAS ENCOUNTERED AT 169 FEET 60 INCHES
336 FEET 60 INCHES FEET INCHES
FEET INCHES FEET INCHES

Formation	Color	Hard or Soft	Top	Bottom	Oil, Gas or Water	Depth Found	Remarks
Clay			0	20			
Lime			20	30			
Gravel			30	34			
Sand, broken			34	60			
Slate Shells			60	169			
Coal			169	174			
Slate Shells			174	200			
Sand			200	220			
Slate			220	240			
Sand			240	290			
Slate & Shells			290	310			
Sand			310	336			
Coal			336	341			
Sand			341	395			
Slate			395	515			
Sand			515	580			
Slate			580	650			
Sand			650	780			
Lime			780	860			
Shells			860	910			
Salt Sand			910	1250	Water	1205	Hole Full
Slate			1250	1262			
Lime			1262	1270			
White Slate Cave			1270	1272			
Lime Shells			1272	1340			
Red Rock			1340	1350			
Shells			1350	1370			
Slate			1370	1390			
Red Rock			1390	1410			
Sand			1410	1450			
Red Rock			1450	1500			
Lime			1500	1520			
Slate			1520	1550			
Lime			1550	1600			
Red Rock			1600	1630			
Shells			1630	1695			
Red Rock			1695	1725			
Slate			1725	1730			

©

APR 28 1915
WEST VIRGINIA
DEPARTMENT OF MINES

Formation	Color	Hard or Soft	Top	Bottom	Oil, Gas or Water	Depth Found	Remarks
Line Shells			1730	1735			
Slate			1735	1744			
Little Lime			1744	1754			
Break			1754	1757			
Line Shells			1757	1812			
Pencil Cave			1812	1819			
Big Lime			1819	1993			
Red Lime			1993	1998			
Lime			1998	2054			
Injun Sand			2054	2100			
Line Shells			2100	2435			
Hard Lime			2435	2435			
Shale			2435	2495			
BEREA SAND			2495	2534	Gas	2513-2527	
Hard Shell			2534	2539	Oil	2527-2534	
Slate			2539	2543			
TOTAL DEPTH:	2543'						

Date April 26, 1946
 THE PURE OIL COMPANY
 BOX 551, NEWARK, OHIO
 APPROVED _____, Owner
 By Frank Miller
 DIVISION _____ (Title) Superintendent