

45 9-20-64

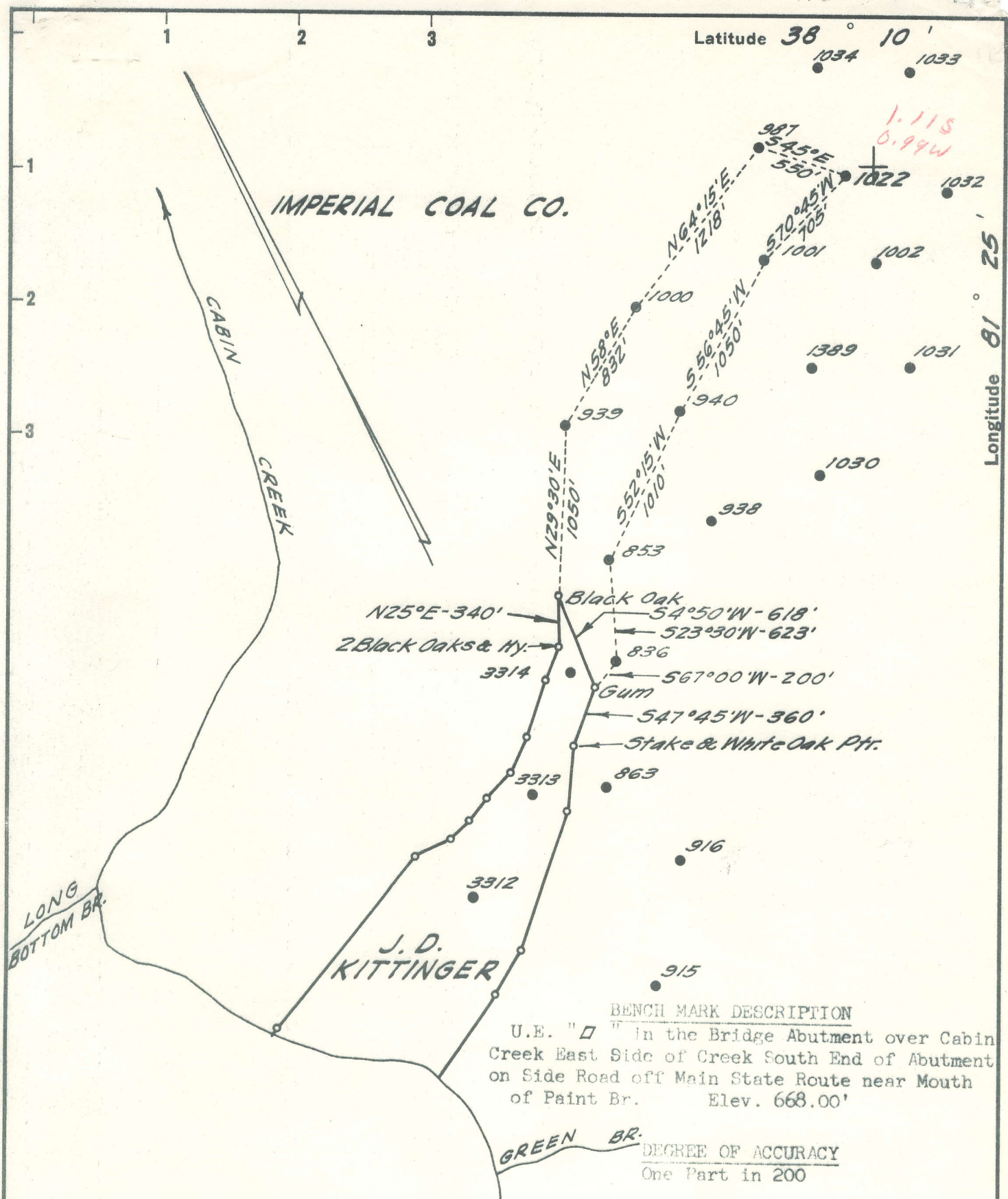

I, the undersigned, hereby certify that this map is correct to the best of my knowledge and belief and shows all the information required by Paragraph 6 of the rules and regulations of the oil and gas section of the mining laws of West Virginia.

Sybert R. Knevel

- New Location ..
- Drill Deeper
- Abandonment.....

Company THE PRESTON OIL CO.
 Address CHARLESTON W.VA.
 Farm IMPERIAL COAL CO.
 Tract _____ Acres 5400 Lease No. 2975
 Well (Farm) No. _____ Serial No. 1022
 Elevation (Spirit Level) 1180.39'
 Quadrangle MONTGOMERY - WV
 County KANAWHA District CABIN CRK
 Engineer Sybert R. Knevel
 Engineer's Registration No. 2529
 File No. 72-45 Drawing No. _____
 Date SEPT. 30, 64 Scale 1"=800'

STATE OF WEST VIRGINIA
 DEPARTMENT OF MINES
 OIL AND GAS DIVISION
 CHARLESTON

WELL LOCATION MAP
 FILE NO. KAN-1379-A

- + Denotes location of well on United States Topographic Maps, scale 1 to 62,500, latitude and longitude lines being represented by border lines as shown.
- Denotes one inch spaces on border line of original tracing.

60 240

IMPERIAL COAL CO. NO. 1022 WELL.

1379A

Cabin Creek District, Kanawha County, W. Va.
 By United Fuel Gas Co., Charleston, W. Va.
 Drilling contractor: U. F. G. Co. Drilling Dept.
 Drillers: R. E. King, E. C. Waller.
 10" casing, 472'; 8 $\frac{1}{4}$ " 1594' (pulled); 6 $\frac{5}{8}$ " 2228'.
 5 $\frac{3}{8}$ " in Oct. 1923. Packer set at 2297' to shut off water in 6 $\frac{5}{8}$ ".
 Steel-line measurements at 1594, 2218, and 2868'.
 Oil well.

	Top.	Bottom.	Thickness.
Sand	0	20	20
Slate	20	40	20
Sand	40	45	5
Coal	45	47	2
Sand	47	80	33
Coal	80	85	5
Slate	85	95	10
Sand	95	200	105
Slate	200	235	35
Coal	235	238	3
Sand	238	333	95
Coal	333	338	5
Slate	338	345	7
Sand	345	355	10
Coal	355	359	4
Slate	359	375	16
Sand	375	408	33
Coal	408	412	4
Sand	412	470	58
Slate	470	495	25
Coal	495	499	4
Slate	499	550	51
Sand	550	720	170
Slate	720	725	5
Sand	725	770	45
Slate	770	830	60
Sand	830	910	80
Slate	910	930	20
Sand	930	1025	95
Slate	1025	1035	10
Sand	1035	1100	65
Slate	1100	1105	5
Sand	1105	1245	140
Salt Sand	1245	1575	330
Slate	1575	1590	15
Lime shells	1590	1610	20
Black slate	1610	1645	35
Red rock	1645	1665	20
Slate	1665	1730	65
Lime	1730	1760	30
Slate	1760	1775	15
Red rock	1775	1865	90
Lime shells	1865	1875	10
Red rock	1875	1932	57
Lime	1932	1942	10
Slate	1942	1990	48
Lime	1990	2045	55

(OVER)

IMPERIAL COAL CO. NO. 1022 WELL (Continued).

	Top.	Bottom.	Thickness.
Maxton Sand	2045	2110	65
Slate	2110	2119	9
Lime	2119	2182	63
Slate	2182	2210	28
Pencil Cave	2210	2218	8
Big Lime	2218	2421	203
Big Injun Sand	2421	2477	56
Slate	2477	2868	391
Berea Sand (show of oil 27 $\frac{1}{2}$ ' in sand)	2868	2904	36
Slate	2904	2905	1
Total depth		2905	

Revised record:

Big Lime	2213		
Berea Sand (pay sand, 2895-2904')	2868	2904	36
Total depth		2905	

KAN-1379-A

WELL RECORD

993

UNITED FUEL GAS

COMPANY

SERIAL WELL NO. 1022

MAP SQUARE

NAME Imperial Coal Company

WELL NO. _____ LEASE NO. _____ ACRES _____

TOWNSHIP OR DISTRICT Cabin Creek

COUNTY Kanawha

FIELD _____

STATE West Virginia

RIG _____ Building Cost _____

Contractor _____

Commenced _____ 19____, Completed _____ 19____

DRILLING _____ Cost per Ft. _____

Contractor U.F.G. Co. Drilling Dept.

Address _____

Commenced _____ 19____, Completed _____ 19____

DRILLERS _____ TOOL DRESSERS _____

R. E. King _____

E. C. Waller _____

CASING AND TUBING		
SIZE	USED IN DRILLING	LEFT IN WELL
16		
13		
10	472'	472'
8 1/4	1594'	-
6 3/8	2228'	2228'
5 3/8		
4 7/8		
4		
3		
2		

WELL TUBED	
Date _____	Tubing or Casing _____
_____ in.	
Size of Packer _____	
Kind of Packer _____	
1st Perf. Set _____ from _____	
2nd Perf. Set _____ from _____	

TEST BEFORE SHOT

_____ of Water in _____ inch

10ths. _____ of Merc. in _____ inch

10ths. Volume _____ Cu. Ft.

TEST AFTER SHOT

_____ of Water in _____ inch

10ths. _____ of Merc. in _____ inch

10ths. Volume _____ Cu. Ft.

Rock Pressure _____

Date Shot _____

Size of Torpedo _____

Oil Flowed _____ bbls. 1st 24 hours

Oil Pumped _____ bbls. 1st 24 hours

Well Abandoned and Plugged _____ 19____

DRILLER'S RECORD

FORMATION	TOP	BOTTOM	THICKNESS	REMARKS
Sand	0	20'	20	
Slate	20'	40'	20	
Sand	40'	45'	5	
Coal	45'	47'	2	
Sand	47'	80'	33	
Coal	80'	85'	5	
Slate	85'	95'	10	
Sand	95'	200'	105	
Slate	200'	235'	35	
Coal	235'	238'	3	
Sand	238'	333'	95	
Coal	333'	338'	5	
Slate	338'	345'	7	
Sand	345'	355'	10	
Coal	355'	359'	4	
Slate	359'	375'	16	
Sand	375'	408'	33	
Coal	408'	412'	4	
Sand	412'	470'	58	
Slate	470'	495'	25	
Coal	495'	499'	4	
Slate	499'	550'	51	
Sand	550'	720'	170	
Slate	720'	725'	5	
Sand	725'	770'	45	
Slate	770'	830'	60	

(Continued)

WELL RECORD

993

UNITED FUEL GAS

COMPANY

SERIAL WELL NO. 1022 (Cont'd) MAP SQUARE

NAME _____

WELL NO. _____ LEASE NO. _____ ACRES _____

TOWNSHIP OR DISTRICT _____

COUNTY _____

FIELD _____

STATE _____

RIG Building Cost _____

Contractor _____

Commenced _____ 19____, Completed _____ 19____

DRILLING Cost per Ft. _____

Contractor _____

Address _____

Commenced _____ 19____, Completed _____ 19____

DRILLERS _____

TOOL DRESSERS _____

CASING AND TUBING		
SIZE	USED IN DRILLING	LEFT IN WELL
16		
13		
10		
8 1/4		
6 5/8		
5 3/16		
4 7/8		
4		
3		
2		

WELL TUBED

Date _____

_____ in. Tubing or Casing

Size of Packer _____

Kind of Packer _____

1st Perf. Set _____ from _____

2nd Perf. Set _____ from _____

TEST BEFORE SHOT

_____ of Water in _____ inch

10ths. _____ of Merc. in _____ inch

10ths. Volume _____ Cu. Ft.

TEST AFTER SHOT

_____ of Water in _____ inch

10ths. _____ of Merc. in _____ inch

10ths. Volume _____ Cu. Ft.

Rock Pressure _____

Date Shot _____

Size of Torpedo _____

Oil Flowed _____ bbls. 1st 24 hours

Oil Pumped _____ bbls. 1st 24 hours

Well Abandoned and Plugged _____ 19____

DRILLER'S RECORD

FORMATION	TOP	BOTTOM	THICKNESS	REMARKS
Sand	830'	910'	80	Big Lime 2218 - 2421'
Slate	910'	930'	20	Injun 2421 - 2477'
Sand	930'	1025'	95	Slate 2477 - 2868'
Slate	1025'	1035'	10	Berea Sand 2868' - 2904'
Sand	1035'	1100'	65	Slate 2904' - 2905'
Slate	1100'	1105'	5	Total Depth 2905'
Sand	1105	1245	140	
Salt Sand	1245	1575	330	
Slate	1575	1590	15	
Lime Shells	1590	1610	20	Show of oil 27-1/2' in sand
Black Slate	1610'	1645	35	
Red Rock	1645	1665	20	Big Lime 2213
Slate	1665	1730	65	Berea Sand 2868-2904
Lime	1730	1760	30	Pay Sand 2895-2904
Slate	1760	1775	15	Total Depth 2905
Red Rock	1775	1865	90	Steel line measurements
Lime Shells	1865	1875	10	1594, 2218 & 2868
Red Rock	1875	1932	57	
Lime	1932	1942	10	
Slate	1942	1990	28 78	
Lime	1990	2045	55	5-3/16" in Oct. 1923
Maxon Sand	2045	2110	5765	Packer set at 2297' to
Slate	2110	2119	9	sheet of water in 6-5/8"
Lime	2119	2182	63	
Slate	2182	2210	28	
Pencil Cover	2210	2218	8	