

LATITUDE 38 ° 05 '

LONGITUDE 82 ° 00 '

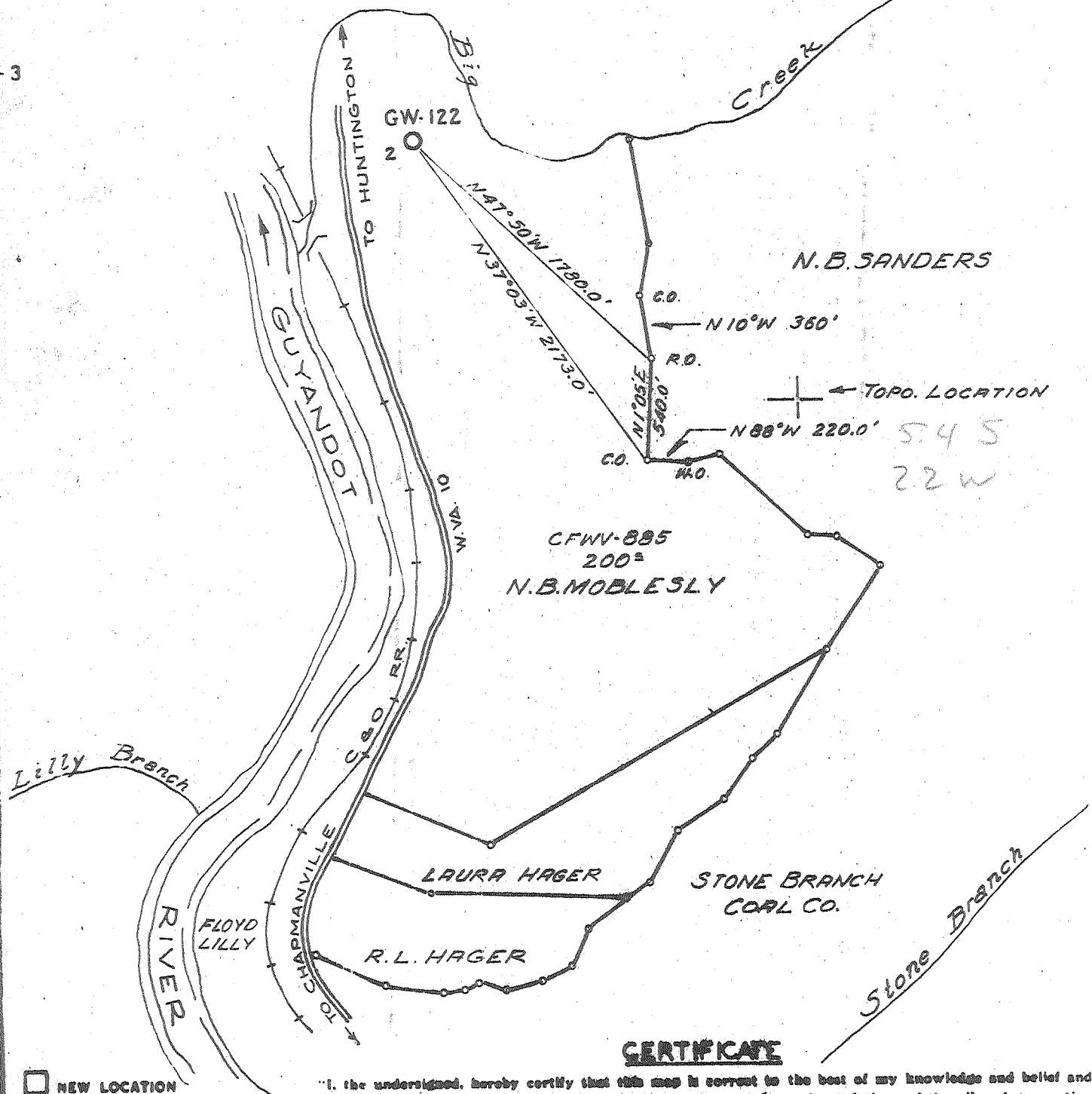

- NEW LOCATION
- RECONDITION
- DRILL DEEPER
- ABANDONMENT

**CERTIFICATE**

"I, the undersigned, hereby certify that this map is correct to the best of my knowledge and belief and shows all the information required by paragraph 6 of the rules and regulations of the oil and gas section of the mining laws of West Virginia."

Minimum degree of accuracy is one part in 200

Signed James G. Day 11/21/72

COMPANY	CITIES SERVICE OIL COMPANY		
ADDRESS	Box 873, CHARLESTON, W. VA.		
FARM	N.B. MOBLESLY		
MAP	SERIES	LEASE NO.	CFNW-885
WELL (FARM) NO.	A-2	SERIAL NO.	GW-122
ELEVATION (SPIRIT LEVEL)	638.00'		
QUADRANGLE	MIDKIFF	SE	GUYANDOT
COUNTY	LOGAN	DISTRICT	CHAPMANVILLE
POINT OF PROVEN ELEVATION	U.S.G.S. "647" CHAPMANVILLE, W.V.		
FILE NO.	DRAWING NO.	N-10-72	
DATE	NOV. 21, 1972	SCALE	1" = 800'

STATE OF WEST VIRGINIA  
 DEPARTMENT OF MINES  
 OIL AND GAS DIVISION  
 CHARLESTON  
**WELL LOCATION MAP**  
 FILE NO. Log-43-(A)

⊕ DENOTES LOCATION OF WELL ON UNITED STATES TOPOGRAPHIC MAPS SCALE 1 TO 62 500. LATITUDE AND LONGITUDE LINES BEING REPRESENTED BY BORDER LINES AS SHOWN.

- DENOTES ONE INCH SPACES ON BORDER LINE OF ORIGINAL TRACING.

205

DEC 15 1972

LATITUDE 38° 05'

LONGITUDE 82° 00'

+ 5.40 S  
2.13 W  
—

7'5 OGIS topo location

7.5' loc \_\_\_\_\_ 15' loc \_\_\_\_\_  
\_\_\_\_\_ (calc.) \_\_\_\_\_

Company Castlebrook

Farm N. B. Mobley 2

Quad \_\_\_\_\_

County Logan

District Chapmanville

WELL LOCATION MAP

File No. <sup>WMS</sup> 045-70016

#4 in 1914. WVGES  
Logan County Report

NOW 30043

STATE OF WEST VIRGINIA  
DEPARTMENT OF MINES  
OIL AND GAS WELLS DIVISION

RECEIVED

MAR 18 1973

OIL & GAS DIVISION  
DEPT. OF MINES

AFFIDAVIT OF PLUGGING AND FILLING WELL

AFFIDAVIT SHOULD BE MADE IN TRIPLICATE, ONE COPY MAILED TO THE DEPARTMENT, ONE COPY TO BE RETAINED BY THE WELL OPERATOR AND THE THIRD COPY (AND EXTRA COPIES IF REQUIRED) SHOULD BE MAILED TO EACH COAL OPERATOR AT THEIR RESPECTIVE ADDRESSES.

*Cities Service Oil Co*  
NAME OF WELL OPERATOR

*Box 723, Charleston 25302*  
COMPLETE ADDRESS

*March 7* 19 *73*  
WELL AND LOCATION

*Logan* District

*Logan* County

Well No. *A 2 GW 122*

*Mobley* Farm

STATE INSPECTOR SUPERVISING PLUGGING *Kenneth Butcher*

AFFIDAVIT

STATE OF WEST VIRGINIA,

County of *Putnam*

SS:

*Kenneth Butcher* and *[Signature]*  
being first duly sworn according to law depose and say that they are experienced in the work of plugging and filling oil and gas wells and were employed by *Cities Service Oil Co*, well operator, and participated in the work of plugging and filling the above well, that said work was commenced on the *2* day of *March*, 19 *73*, and that the well was plugged and filled in the following manner:

SAND OR ZONE RECORD FORMATION	FILLING MATERIAL	PLUGS USED SIZE & KIND	CASING	
			CSS PULLED	CSS LEFT IN
<i>LIME</i>	<i>CEMENT 2" TUBING</i>	<i>1275 TO SURFACE</i>	<i>1"</i>	<i>8 3/4"</i>
<i>SLATE</i>	<i>Gravel</i>	<i>546 TO 525</i>		<i>7"</i>
<i>SLATE COAL &amp; SAND</i>	<i>CEMENT</i>	<i>525 TO 450</i>		<i>2"</i>
<i>SAND</i>	<i>Gravel</i>	<i>210 TO 190</i>		
<i>SLATE, SAND,</i>	<i>CEMENT</i>	<i>190 TO SURFACE</i>		
COAL SEAMS		DESCRIPTION OF MONUMENT		
(NAME)		<i>Cities Service Oil Co</i>		
(NAME)		<i>Plugged 3-7-73</i>		
(NAME)		<i>Mobley A 2 GW 122</i>		
(NAME)		<i>3-7-73</i>		

and that the work of plugging and filling said well was completed on the *7* day of *March*, 19 *73*.

And further deponents saith not.

Sworn to and subscribed before me this *7* day of *March*, 19 *73*

My commission expires:

*Sept 23 1979*

*[Signature]*

*[Signature]*  
Notary Public.

Permit No. LOG-43(A)

MAR 19 1973