

LATITUDE 39° 40' 00"

LONGITUDE 80° 12' 30"

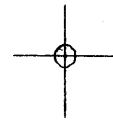

7'5 OGIS topo location

7.5' LOC 2.745 15' LOC \_\_\_\_\_  
' 0.68W (calc.) \_\_\_\_\_

Company \_\_\_\_\_

Farm \_\_\_\_\_

Quad BLACKSVILLE 7 1/2'

County MONONGALIA

District CLAY

WELL LOCATION MAP

File No. OGI- 539

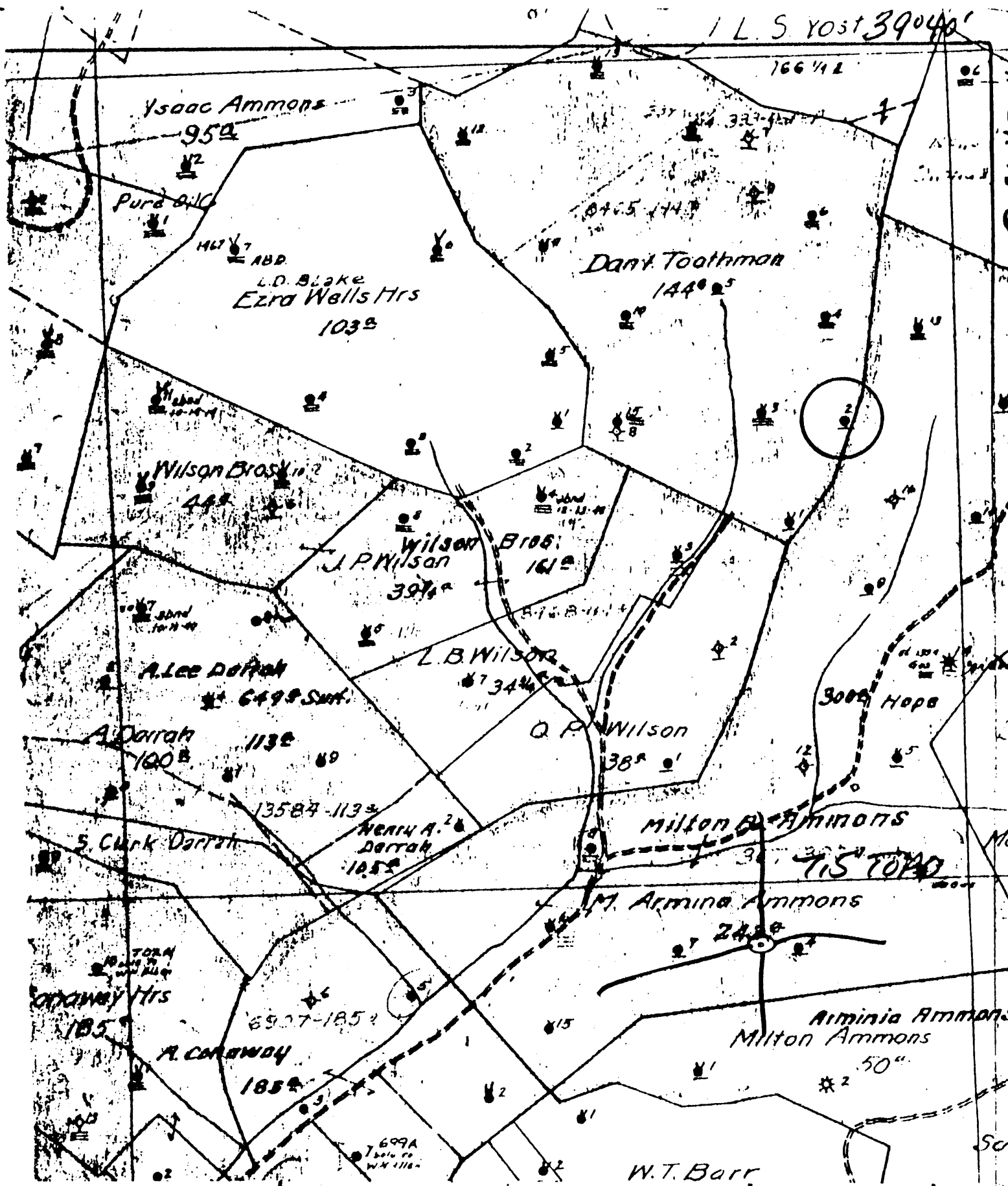

DENOTES LOCATION OF  
 LL ON UNITED STATES  
 TOPOGRAPHIC MAPS

RM IV-6  
 -78

62E N12E22



STATE OF WEST VIRGINIA  
 DEPARTMENT OF MINES  
 OIL AND GAS DIVISION

LL TYPE: OIL  GAS \_\_\_\_\_ LIQUID INJECTION \_\_\_\_\_ WASTE DISPOSAL \_\_\_\_\_  
 ( IF "GAS", PRODUCTION \_\_\_\_\_ STORAGE \_\_\_\_\_ DEEP \_\_\_\_\_ SHALLOW \_\_\_\_\_  
 LOCATION: ELEVATION 1425 WATER SHED BENNEFIELD PRODUK  
 DISTRICT CLAY COUNTY MONONGALIA  
 QUADRANGLE BLACKSVILLE 715

SURFACE OWNER \_\_\_\_\_ ACREAGE \_\_\_\_\_  
 GAS ROYALTY OWNER \_\_\_\_\_ LEASE ACREAGE \_\_\_\_\_

PROPOSED WORK: DRILL \_\_\_\_\_ CONVERT \_\_\_\_\_ DRILL DEEPER \_\_\_\_\_ REDRILL \_\_\_\_\_ FRACTURE OR  
 STIMULATE \_\_\_\_\_ PLUS OFF OLD FORMATION \_\_\_\_\_ PERFORATE NEW  
 FORMATION \_\_\_\_\_ OTHER PHYSICAL CHANGE IN WELL (SPECIFY) \_\_\_\_\_

PLUG AND ABANDON \_\_\_\_\_ CLEAN OUT AND REPLUG \_\_\_\_\_  
 RESET FORMATION \_\_\_\_\_ ESTIMATED DEPTH \_\_\_\_\_

LL OPERATOR Pennzoil Company DESIGNATED AGENT James A. Crews  
 ADDRESS P. O. Box 1588 ADDRESS P. O. Box 1588  
Parkersburg, WV 26101 Parkersburg, WV 26101

DATE 1-24-1979  
 OPERATOR'S WELL NO. 2  
 API WELL NO. \_\_\_\_\_  
47-061-0539  
 STATE COUNTY PERMIT

Well No. 2 <sup>A.B.</sup> S. L. (Anford) Boothman Farm 40 Acres  
 Lease No. 9091 Manning <sup>District</sup> Marion County N. W. State  
 Contractor Lo. Perry City Out Tools Contractor  
 Drilling <sup>Super</sup> Commenced 10-7-1941 Drilling <sup>Super</sup> Completed 10-17-1941  
 N. 10 S. E. 17 W. Elevation

Rock Formation	Top	Bottom	Steel Line Measurement	Remarks						
Commenced Drilling Super at bottom of Gordon Sand		3449								
Slate + Shale (soft)	3449	3475								
Fourth Sand	3475	3495								
See 2.5 W. 3/4" Orf.	3478	3482		20,551 Cu. Ft.						
Slate + Shale (soft)	3495	3625								
Fifth Sand	3625	3630		Any.						
Slate + Shale (soft)	3630	3728								
Total Depth		3728	3728							
Hole filled back to		3508	3508							
<u>Special Volume &amp; Pressure Reports</u>										
DATE	Openings	1 Min.	2 Min.	3 Min.	4 Min.	5 Min.	10 Min.	15 Min.	1 Hr.	24 Hrs.
11-5-41	2"	1	1	2	2	3	4	6	12	47" Super Sand 49" 10788 Sand
See ending into hole after drilling Super - 15,332 Cu. Ft.										

**CASING RECORD AS TALLIED. NOT STEEL LINE MEASUREMENT.**

Size	Put in Well		Pulled Out		Left in Well		Shot Date 10-21-41 Amount 20 lbs (Dump) Sand 3477-3484 Result See end after shot. 8 Water 1" depth 21,007 Cu. Ft.  Packer Size  Depth Set
	Foot	In.	Foot	In.	Foot	In.	
-							

Production First 24 Hours \_\_\_\_\_ Bbls. Gas Test 2.5 W 3/4" Orf - 20,551 Cu. Ft.  
 Approved by J. G. Knecht Superintendent

Well No. 2 - E. B. Toothman Farm 95<sup>5</sup> Acres  
 Lease No. 19559 - Clay District ~~Monroe~~ County W. Va. State  
 Contractor Contractor

Drilling Commenced 8-8-1903 Drilling Completed 11-14-1903.  
 N. S. E. W. Elevation

Rock Formation	Top	Bottom	Steel Line Measurement	Remarks
Pittsburgh Coal	750			
Levin	2050	2187		
Pay Sand	2155	2160		
Bayard	8167			
Pay Sand	3167	3184		
Total Depth		3184		

Date.	Shots.	Amnt.	Top of shot
3-7-13		30 qt	3165
1-12-04		24 "	3166
3-25-04		40 "	3165
3-26-08		20 "	3166

CASING RECORD AS TALLIED. NOT STEEL LINE MEASUREMENT.

Put in Well	Pulled Out	Left in Well	Shot Date
Size	Feet	In	Amount
6 1/8	1760		Sand
5 7/8	2179		Result
4 1/2 line	699	3 sec. 17 ft. line. 11 ft to 21 + 10 ft last.	Packer Size
			Depth Set

Production First 24 Hours Oil Bbls. Gas Test

Approved by \_\_\_\_\_ Superintendent