

WDTN28FHSM  
CNX Gas Company LLC



Matchline Sheet 2  
Matchline Sheet 1

AZ 325°00'00"  
17,863'±

500' WELL BORE BUFFER  
SHOWING EXISTING WELLS

WDTN28FHSM  
LANDING POINT

**NOTES ON SURVEY**

1. COORDINATES SYSTEM IS UTM, NAD 83 DATUM, ZONE 17, U.S. FOOT AND WELL COORDINATES ESTABLISHED USING SURVEY GRADE GPS.
2. SURFACE AND ROYALTY OWNER INFORMATION AND THEIR BOUNDARIES SHOWN HEREON WERE OBTAINED FROM INFORMATION PROVIDED BY CNX GAS COMPANY LLC AND TAX RECORDS.
3. THIS PLAT DOES NOT REPRESENT A BOUNDARY SURVEY OF THE PARCELS SHOWN HEREON.
4. NO DWELLINGS AND BUILDINGS WITHIN 625 FEET OF PROPOSED WELL OF CENTER OF PAD.
5. NO WATER WELLS OR DEVELOPED SPRINGS WITHIN 250 FEET OF PROPOSED WELL.
6. NO PERENNIAL STREAMS, LAKES, PONDS, RESERVOIRS OR WETLANDS WITHIN 100 FEET OF THE LIMITS OF DISTURBANCE.
7. NO NATURALLY PRODUCING TROUT STREAM WITHIN 300 FEET OF LIMITS OF DISTURBANCE.

**LEGEND**

- Active Well
- Proposed Gas Well
- Located Corner, as noted
- Surface Tract Identification
- Proposed Gas Well
- Located Corner, as noted
- Surface Tract Lines
- Reference Line
- Match Line
- Lease Boundary
- Creek or Drain
- State Line
- WV County Route
- WV State Route

See Page 3 For Surface Owners and Lessors

( ) Denotes Location of Well on United States Topographic Maps



I, the undersigned, hereby certify that this plat is correct to the best of my knowledge and belief and shows all the information required by law and the regulations issued and prescribed by the Department of Environmental Protection.

*L. L. S. 2394*  
L. L. S. 2394



SEAL

FILE NO: \_\_\_\_\_  
 DRAWING NO: \_\_\_\_\_  
 SCALE: 1" = 2000'  
 MINIMUM DEGREE OF ACCURACY: 1:2500  
 PROVEN SOURCE OF ELEVATION: NGS CORS Station

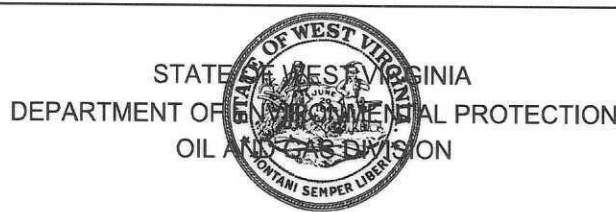

DATE: April 21, 20 26  
 OPERATORS WELL NO: WDTN28FHSM  
 API WELL NO: 47 - 061 - 02024  
 STATE COUNTY PERMIT

WELL TYPE:  OIL  GAS  LIQUID INJECTION  WASTE DISPOSAL  
 (IF GAS) PRODUCTION:  STORAGE  DEEP  SHALLOW  
 LOCATION ELEVATION: 1457' WATERSHED: Dunkard Creek QUADRANGLE: Hundred  
 DISTRICT: Battelle COUNTY: Monongalia  
 SURFACE OWNER: Consol Mining Company LLC ACREAGE: 68.37 ±  
 ROYALTY OWNER: CNX Gas Company Company, LLC LEASE NO: 189437000 ACREAGE: 68.37 ±  
 PROPOSED WORK:  DRILL  CONVERT  DRILL DEEPER  FRACTURE OR STIMULATE  PLUG OFF OLD FORMATION  
 PERFORATE NEW FORMATION  OTHER PHYSICAL CHANGE IN WELL (SPECIFY)  
 PLUG AND ABANDON  CLEAN OUT AND REPLUG TARGET FORMATION: Marcellus ESTIMATED DEPTH: TVD: 8,059'  
 WELL OPERATOR: CNX Gas Company LLC DESIGNATED AGENT: Anthony Kendziora  
 ADDRESS: 1000 Horizon Vue Drive ADDRESS: 111 Avondale Road  
 Canonsburg, PA 15317 Fairmont, WV 26554

05/15/2026

WDTN28FHSM  
CNX Gas Company LLC



WDTN28FHSM  
BOTTOM HOLE

PENNSYLVANIA  
GREENE COUNTY

WEST VIRGINIA  
MONONGALIA  
COUNTY

**NOTES ON SURVEY**

1. COORDINATES SYSTEM IS UTM, NAD 83 DATUM, ZONE 17, U.S. FOOT AND WELL COORDINATES ESTABLISHED USING SURVEY GRADE GPS.
2. SURFACE AND ROYALTY OWNER INFORMATION AND THEIR BOUNDARIES SHOWN HEREON WERE OBTAINED FROM INFORMATION PROVIDED BY CNX GAS COMPANY LLC AND TAX RECORDS.
3. THIS PLAT DOES NOT REPRESENT A BOUNDARY SURVEY OF THE PARCELS SHOWN HEREON.
4. NO DWELLINGS AND BUILDINGS WITHIN 625 FEET OF PROPOSED OF CENTER OF PAD.
5. NO WATER WELLS OR DEVELOPED SPRINGS WITHIN 250 FEET OF PROPOSED WELL.
6. NO PERENNIAL STREAMS, LAKES, PONDS, RESERVOIRS OR WETLANDS WITHIN 100 FEET OF THE LIMITS OF DISTURBANCE.
7. NO NATURALLY PRODUCING TROUT STREAM WITHIN 300 FEET OF LIMITS OF DISTURBANCE.

**LEGEND**

- Active Well
- Proposed Well Location
- Future Use
- Surface Tree Identification
- Proposed Gas Well
- Located Corner, as noted
- Surface Tract Lines
- Reference Line
- Match Line
- Lease Boundary
- Creek or Drain
- State Line
- WV County Route
- WV State Route

See Page 3 For Surface Owners and Lessors

( ) Denotes Location of Well on United States Topographic Maps

500' WELL BORE BUFFER  
SHOWING EXISTING WELLS



SEAL

I, the undersigned, hereby certify that this plat is correct to the best of my knowledge and belief and shows all the information required by law and the regulations issued and prescribed by the Department of Environmental Protection.

*T. L. S. 2394*  
L. L. S. 2394



STATE OF WEST VIRGINIA  
DEPARTMENT OF ENVIRONMENTAL PROTECTION  
OIL AND GAS DIVISION

FILE NO:  
DRAWING NO:  
SCALE: 1" = 2000'  
MINIMUM DEGREE OF ACCURACY:  
1:2500  
PROVEN SOURCE OF ELEVATION:  
NGS CORS Station

DATE: April 21, 20 26  
OPERATORS WELL NO: WDTN28FHSM  
API WELL NO  
47 - 061 - 02024  
STATE COUNTY PERMIT

WELL TYPE:  OIL  GAS  LIQUID INJECTION  WASTE DISPOSAL  
(IF GAS) PRODUCTION:  STORAGE  DEEP  SHALLOW  
LOCATION ELEVATION: 1457' WATERSHED: Dunkard Creek QUADRANGLE: Hundred  
DISTRICT: Battelle COUNTY: Monongalia  
SURFACE OWNER: Consol Mining Company LLC ACREAGE: 68.37 ±  
ROYALTY OWNER: CNX Gas Company Company, LLC LEASE NO: 189437000 ACREAGE: 68.37 ±  
PROPOSED WORK:  DRILL  CONVERT  DRILL DEEPER  FRACTURE OR STIMULATE  PLUG OFF OLD FORMATION  
 PERFORATE NEW FORMATION  OTHER PHYSICAL CHANGE IN WELL (SPECIFY)  
 PLUG AND ABANDON  CLEAN OUT AND REPLUG TARGET FORMATION: Marcellus ESTIMATED DEPTH: TVD: 8,059'  
WELL OPERATOR: CNX Gas Company LLC DESIGNATED AGENT: Anthony Kendziora  
ADDRESS: 1000 Horizon Vue Drive ADDRESS: 111 Avondale Road  
Canonsburg, PA 15317 Fairmont, WV 26554

05/15/2026

TRACT ID	SURFACE OWNER	LESSOR	PIN
1	Consol Mining Company LLC	John G. Donelan, single John G. Donelan, single; Dorothy E. Szymanski and Bruno Szymanski, w/h Consolidation Coal Company CNX Gas Company LLC Noble Energy, Inc.	1-12-17
2	Consol Mining Company LLC	Bounty Minerals, LLC David L. Liming and Nancy A. Liming, h/w	1-12-2
9	Consol Mining Company LLC	Bounty Minerals, LLC	p/o 1-12-3
10	Consol Mining Company LLC	Fred C. Park, et al Consolidation Coal Company CONSOL Mining Company LLC CNX Resource Holdings LLC Joseph S. Delaney Michael S. Delaney Earlene Owens and Robert Owens, w/h Nancy Paulovicks and Jay E. Paulovicks, w/h Martha A. Pryor, a/k/a Martha Ann Pryor by Robert Owens as Agent W. James Shannon Leon E. Delaney Jeff T. Delaney Mary Ellen Bell Lee E. Delaney Martha Ann Price George William Cummins, Jr. David Allen Jolliffe and Donna Sue A. Jolliffe, h/w Lisa Ellen May and Gary A. May, w/h	1-9-35

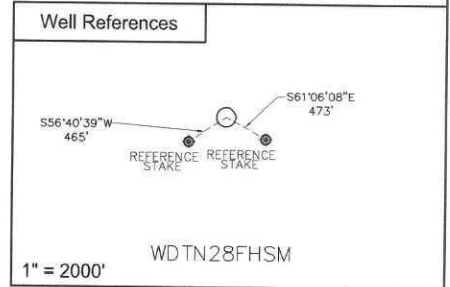
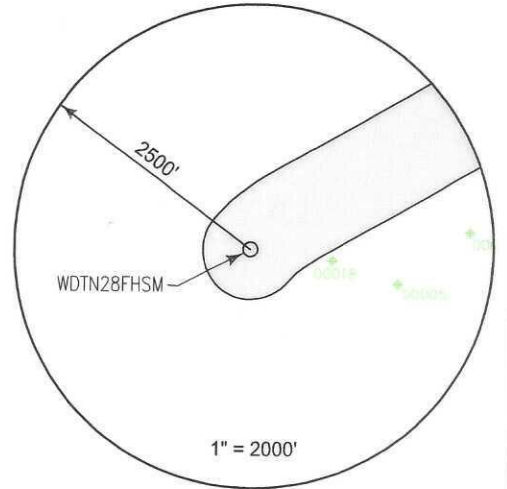

SURFACE HOLE LOCATION (SHL)	
UTM 17 NAD 83	N: 4392595.544 E: 552952.236
NAD 83, WV NORTH	N: 431575.405 E: 1720124.777
LAT/LON DATUM NAD 83	
LAT: 39°40'53.580" LON: 80°22'57.067"	
LANDING POINT	
UTM 17 NAD 83	N: 4393366.218 E: 553760.617
NAD 83, WV NORTH	N: 434059.959 E: 1722819.635
LAT/LON DATUM NAD 83	
LAT: 39°41'18.395" LON: 80°22'22.907"	
BOTTOM HOLE LOCATION (BHL)	
UTM 17 NAD 83	N: 4397772.113 E: 550564.795
NAD 83, WV NORTH	N: 448692.643 E: 1712574.492
LAT/LON DATUM NAD 83	
LAT: 39°43'32.004" LON: 80°24'35.857"	



I, the undersigned, hereby certify that this plat is correct to the best of my knowledge and belief and shows all the information required by law and the regulations issued and prescribed by the Department of Environmental Protection.

*Terry Lee Rowe*  
L. L. S. 2394

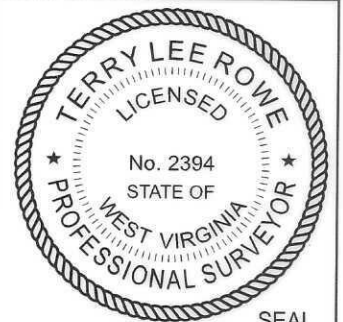

FILE NO:  
DRAWING NO:  
SCALE: 1" = 1000'  
MINIMUM DEGREE OF ACCURACY:  
1:2500  
PROVEN SOURCE OF ELEVATION:  
NGS CORS Station



DATE: April 21, 20 26  
OPERATORS WELL NO: WDTN28FHSM  
API WELL NO  
47 - 061 - 02024  
STATE COUNTY PERMIT

WELL TYPE:  OIL  GAS  LIQUID INJECTION  WASTE DISPOSAL  
(IF GAS) PRODUCTION:  STORAGE  DEEP  SHALLOW

LOCATION ELEVATION: 1457' WATERSHED: Dunkard Creek QUADRANGLE: 10515/2026

DISTRICT: Battelle COUNTY: Monongalia

SURFACE OWNER: Consol Mining Company LLC ACREAGE: 68.37 ±  
ROYALTY OWNER: CNX Gas Company Company, LLC LEASE NO: 189437000 ACREAGE: 68.37 ±

PROPOSED WORK:  DRILL  CONVERT  DRILL DEEPER  FRACTURE OR STIMULATE  PLUG OFF OLD FORMATION  
 PERFORATE NEW FORMATION  OTHER PHYSICAL CHANGE IN WELL (SPECIFY)  
 PLUG AND ABANDON  CLEAN OUT AND REPLUG TARGET FORMATION: Marcellus ESTIMATED DEPTH: TVD: 8,059'

WELL OPERATOR: CNX Gas Company LLC DESIGNATED AGENT: Anthony Kendziora  
ADDRESS: 1000 Horizon Vue Drive ADDRESS: 111 Avondale Road  
Canonsburg, PA 15317 Fairmont, WV 26554

TRACT ID	SURFACE OWNER	LESSOR	PIN
11	Consol Mining Company LLC	Mike Ross, Inc. Waco Oil & Gas Co., Inc.	1-9-29
13A	Consol Mining Company LLC	Donald C. Clovis and Donna P. Clovis, h/w	1-9-28 1-9-28.1 p/o 1-9-28.2
13B	Consol Mining Company LLC	Donald C. Clovis and Donna P. Clovis, h/w	1-9-27 p/o 1-9-28.2
20	Consol Mining Company LLC	Carole Ann Martin Consolidation Coal Company Consol Mining Company LLC CNX Resource Holdings LLC	1-9-26
21	Consol Mining Company LLC	Edgar A. Moore, Jr. and Seth Allen Moore Consolidation Coal Company Consol Mining Company LLC CNX Resource Holdings LLC Donald C. Clovis and Donna P. Clovis, h/w	1-9-27.1
22	CNX RCPC LLC	Milan W. Cikovich, Jr. and Susan K. Cikovich Steven E. Hennen Gregory S. Clark Carl J. Woods Mark A. Clark Beverly A. Tonge Wanda Lee Shaffer Denzil L. Hennen and Bonnie L. Hennen, h/w Eugene D. Hennen Nancy K. Haddix Carolyn S. Moore and James E. Moore, w/h Charlie Fudge Mary Sargent Hennen Belinda T. Shriver and Chalres C. Shriver, w/h Donna K. Wickham Denise Mitchell Marjorie Woods White James R. Hennen, Jr. Judy Kay Marshall and Graham Marshall, h/w Mary Virginia Davis EQT Production Company Donna R. Hennen WOG Leaseing, LLC Betty Short Don Fordyce Mildred Louise Walton Linda S. Sansone and Charles F. Sansone, w/h Karen S. Gray Helene M. Muetzel Cecil Hennen Roger L. Pratt Milan W. Cikovich, Jr., individually and as Trustee of the Amended and Restated Milan W. Cikovich Testamentary Trust F/B/O Francine R. Cikovich, and Christine Michelle Park, individually and as Trsutee of the Amended and Restated Milan W. Cikovich Testamentary Trust F/B/O Francine R. Cikovich Melissa Ann Hennen Limbaugh Three Rivers Royalty II, LLC Connie Jean Thompson Hennen Richard P. Hennen Bonnie Lee Hennen Winnen David L. Liming and Nancy A. Liming, h/w Herbert Lee Haines and Linda R. Haines, h/w Helen Pecora Dorothy Chohrach Patricia A. Cooney Nancy Irwin Singer James C. Irwin Jeannette Irwin Prout St. John's Evangelical Protestant Church Deborah L. Hennen William E. Hennen Heather M. Hennen Jeremy M. Hennen Francis J. Waldron Hennen Delores Ann Hennen Bryant Joseph Muto Clark H. Hennen Ronald Fordyce James Cox Ralph E. Hixenbaugh Frank Hennen Frank Hennen Carol A. Irwin Bernard A. Yocke	p/o 1-9-21

05/15/2026

TRACT ID	SURFACE OWNER	LESSOR	PIN
23	Consol Mining Company LLC	Russell Scotchell and Robin G. Scotchell, h/w	1-9-22
		Consolidation Coal Company	
		Consol Mining Company LLC	
		CNX Resource Holdings LLC	
TRACT ID	SURFACE OWNER	LESSOR	PIN
38A	James Mark Faber, et al	James Mark Faber	1-10-7 1-10-7.1 1-10-6
TRACT ID	SURFACE OWNER	LESSOR	PIN
39	David and Gail Henderson	David Henderson and Gail Henderson, h/w	1-10-4
		Antero Resources Corporation	
TRACT ID	SURFACE OWNER	LESSOR	PIN
40	David and Gail Henderson	David Henderson and Gail Henderson, h/w	1-10-6
		Antero Resources Corporation	
		Joseph David Cross	
TRACT ID	SURFACE OWNER	LESSOR	PIN
41	David and Gail Henderson	David Henderson and Gail Henderson, h/w	1-10-6
		Antero Resources Corporation	
		Joseph David Cross	
		William Charles Booth	
		David Lee Booth	
		Daniel Bruce Booth	
		Gary Allan Booth	
		Janet Lynn Dorsey Stukins	
		Janice Kay Dorsey Whitaker	
		Kenneth Jeffrey Campbell	
		Robert William Campbell	
		James W. Dorsey	
		Judith Ann Booth Taylor	
TRACT ID	SURFACE OWNER	LESSOR	PIN
42A	David and Gail Henderson	David Henderson and Gail Henderson, h/w	1-10-5
		Antero Resources Corporation	
		Kenneth Jeffrey Campbell	
		Robert William Campbell	
		James W. Dorsey	
		Gary Allan Booth	
		Gary Arthur Kesteven	
		David Lee Booth	
		Janice Kay Dorsey Whitaker	
		Janet Lynn Dorsey Stukins	
		Wendy C. Hershey	
		Daniel Bruce Booth	
		William Charles Booth	
		Judith Ann Booth Taylor	
TRACT ID	SURFACE OWNER	LESSOR	PIN
42B	David and Gail Henderson	David Henderson and Gail Henderson, h/w	1-10-5
		Antero Resources Corporation	
		Kenneth Jeffrey Campbell	
		Robert William Campbell	
		James W. Dorsey	
		Gary Allan Booth	
		Gary Arthur Kesteven	
		David Lee Booth	
		Janice Kay Dorsey Whitaker	
		Janet Lynn Dorsey Stukins	
		Wendy C. Hershey	
		Daniel Bruce Booth	
		William Charles Booth	
		Judith Ann Booth Taylor	
TRACT ID	SURFACE OWNER	LESSOR	PIN
43A	Frank G. Cox, Jr., et al	Frank G. Cox, Jr.	1-1-6
		Amy Vandenberghe	
		Antero Resources Corporation	
		Antero Resources Corporation	
TRACT ID	SURFACE OWNER	LESSOR	PIN
43B	Frank G. Cox, Jr., et al	Frank G. Cox, Jr.	1-1-6
		Amy Vandenberghe	
		Antero Resources Corporation	
		Antero Resources Corporation	
		XTO Energy, Inc.	

05/15/2026

TRACT ID	SURFACE OWNER	LESSOR	PIN
43C	Frank G. Cox, Jr., et al	Frank G. Cox, Jr.	1-1-6
		Amy Vandenberghe	
		Antero Resources Corporation	
		Antero Resources Corporation	
		XTO Energy, Inc.	
TRACT ID	SURFACE OWNER	LESSOR	PIN
51A	Cucumber Tree Farm Inc.	Cucumber Tree Farm, Inc.	1-1-9
		Mountain V Oil and Gas, Inc.	
		Hayden Harper Energy Pennsylvania, LLC	
		Bluestone Energy Partners	
		Antero Resources Bluestone LLC	
		Antero Resources Appalachian Corporation	
		Energy Corporation of America	
		EQT Production Company	
TRACT ID	SURFACE OWNER	LESSOR	PIN
51B	Cucumber Tree Farm Inc.	Cucumber Tree Farm, Inc.	1-1-7
		Mountain V Oil and Gas, Inc.	
		Hayden Harper Energy Pennsylvania, LLC	
		Bluestone Energy Partners	
		Antero Resources Bluestone LLC	
		Antero Resources Appalachian Corporation	
		Energy Corporation of America	
		EQT Production Company	
		EQT Production Company	
TRACT ID	SURFACE OWNER	LESSOR	PIN
52	R. Allan Shipman	Energy Corporation of America	1-1-5
		EQT Production Company	
		EQT Production Company	

05/15/2026