

NOTE :- Shown is a 130 ac. tract, a part of a 435 ac. tract.

OWNERSHIP
Fee title is vested in Gene and Louise Carr
No coal is mined, if any, in Pleasants County.

LEGEND

- Plotted from deed calls
- Surveyed Lines
- o Well Location

Minimum Error of Closure 1 in 200'

Source of Elevation USGS B.M. at Aruilla = 636'

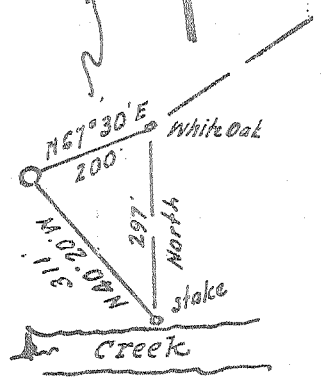

DETAIL

- Fracture.....
- New Location.....
- Drill Deeper.....
- Abandonment.....

I, the undersigned, hereby certify that this map is correct to the best of my knowledge and belief and shows all the information required by paragraph 6 of the rules and regulations of the oil and gas section of the mining laws of West Virginia.

Signed: W. S. Carr
Squares: N S E W

Map No.

Company LAUDERMAN OIL & GAS CO. ^{DRILLING}
 Address P.O. Box 266, Plevin City, W. Va.
 Farm Gene and Louise Carr
 Tract _____ Acres 435 Lease No. _____
 Well (Farm) No. One Serial No. _____
 Elevation (Spirit Level) 746 ^{NE}
 Quadrangle Bens Run 7 1/2, St Marys 15'
 County Pleasants District Union
 Engineer W. S. Carr
 Engineer's Registration No. 1227
 File No. _____ Drawing No. _____
 Date April 25, 1979 Scale 1" =

STATE OF WEST VIRGINIA
DEPARTMENT OF MINES
OIL AND GAS DIVISION
CHARLESTON

WELL LOCATION MAP

FILE NO. 47-073-0761

+ Denotes location of well on United States Topographic Maps, scale 1 to 24,000 or 62,500, latitude and longitude lines being represented by border lines as shown.

— Denotes one inch spaces on border line of original tracing.

JUN 14 1979



STATE OF WEST VIRGINIA
DEPARTMENT OF MINES

RECEIVED

MAY 21 1979

Oil and Gas Division

OIL & GAS DIVISION
DEPT. OF MINES

OIL AND GAS WELL PERMIT APPLICATION

TO THE DEPARTMENT OF MINES,
Charleston, W. Va.

DATE May 3, 1979

Surface Owner Gene and Louise Carr

Company Lauderman Oil & Gas Drilling

Address Friendly, W. Va. 26146

Address 311 South 4th Ave. Paden City, WV

Mineral Owner Gene and Louise Carr

Farm Gene and Louise Carr Acres 435

Address Friendly, W. Va. 26146

Location (waters) Middle Island Creek

Coal Owner No coal in Pleasants County

Well No. ONE Elevation 746

Address _____

District Union County Pleasants

Coal Operator Pleasants left out

Quadrangle Bens Run 7 1/2

~~THIS PERMIT MUST BE POSTED AT THE WELL SITE~~

All provisions being in accordance with Chapter 22, of the W. Va. Code, the location is hereby approved for drilling. This permit shall expire if operations have not commenced by 1-29-80.

INSPECTOR
TO BE Mr. Phillip Tracy
173 Dodd St.
ADDRESS Middlebourne, WV 26149
PHONE Ph: 758-4573

Robert J. [Signature]
Deputy Director - Oil & Gas Division

GENTLEMEN:

The undersigned well operator is entitled to drill upon the above named farm or tract of land for oil and gas, having fee title thereto, (or as the case may be) under grant or lease dated November 1 1979 by Gene and Louise Carr made to Lauderman Oil & Gas and recorded on the _____ day of _____ 19____, in _____ County, Book _____ Page _____

NEW WELL _____ DRILL DEEPER _____ REDRILL _____ FRACTURE OR STIMULATE
_____ OIL AND GAS WELL ORIGINALLY DRILLED BEFORE JUNE 5, 1969.

The enclosed plat was prepared by a registered engineer or licensed land surveyor and all coal owners and/or operators have been notified as of the above date.

The above named coal owners and/or operator are hereby notified that any objection they wish to make, or are required to make by Section 3 of the Code, must be received by, or filed with the Department of Mines within ten (10) days. *

Copies of this notice and the enclosed plat were mailed by registered mail, or delivered to the above named coal operators or coal owners at their above shown respective address 4th day MAY, 1979 before, or on the same day with the mailing or delivery of this copy to the Department of Mines at Charleston, West Virginia.

PLEASE SUBMIT COPIES OF ALL GEOPHYSICAL LOGS DIRECTLY TO:

WEST VIRGINIA GEOLOGICAL AND ECONOMIC SURVEY
P. O. BOX 879
MORGANTOWN, WEST VIRGINIA 26505
AC-304 - 292-6331

Address of Well Operator

Very truly yours, LAUDERMAN OIL & GAS DRILLING
(Sign Name) Phillip Tracy
Well Operator
311 South 4th Avenue
Street
Paden City
City or Town
West Virginia 26159
State

*SECTION 3 If no objections are filed or found by the Department of mines, within said period of ten days from the receipt of notice and plat by the department of mines, to said proposed location, the department shall forthwith issue to the well operator a permit reciting the filing of such plat, that no objections have been made by the coal operators or found thereto by the department and that the same is approved and the well operator authorized to proceed.

BLANKET BOND

47-073-0761 PERMIT NUMBER

"I have read and understand the reclamation requirements as set forth in Chapter 22, Article 4, Section 12-b and will carry out the specified requirements."

Signed by [Signature]

THIS IS AN ESTIMATE ONLY
ACTUAL INFORMATION WILL BE SUBMITTED ON OG-10 UPON COMPLETION

PROPOSED WORK ORDER TO ✓ DRILL _____ DEEPEN _____ FRACTURE-STIMULATE _____
 DRILLING CONTRACTOR: (If Known) _____ RESPONSIBLE AGENT: _____
 NAME Johnson Drilling _____ NAME Ernest Herbold _____
 ADDRESS Rt. 6 Smith Dr., Marietta, Ohio _____ ADDRESS P.O. Box 266, Paden City, W.Va. _____
 TELEPHONE 614-373-0877 45750 _____ TELEPHONE (304) 657-2701 _____
 ESTIMATED DEPTH OF COMPLETED WELL: 3200 _____ ROTARY ✓ _____ CABLE TOOLS _____
 PROPOSED GEOLOGICAL FORMATION: Gordon & Ohio Shales _____
 TYPE OF WELL: OIL _____ GAS _____ COMB. ✓ _____ STORAGE _____ DISPOSAL _____
 RECYCLING _____ WATER FLOOD _____ OTHER _____

TENTATIVE CASING PROGRAM:

CASING AND TUBING SIZE	USED FOR DRILLING	LEFT IN WELL	CEMENT FILL UP OR SACKS - CUBIC FT.
20 - 16			
13 - 10			
9 - 5/8	900' Cemented to surface		
8 - 5/8			
7			
5 1/2	4 1/2' Cemented thru payzone		
4 1/2			
3			Perf. Top
2			Perf. Bottom
Liners			Perf. Top
			Perf. Bottom

APPROXIMATE FRESH WATER DEPTHS 60-100 FEET _____ SALT WATER 1700 FEET _____
 APPROXIMATE COAL DEPTHS 460 if any coal--Pleasants County left out _____
 IS COAL BEING MINED IN THE AREA? No _____ BY WHOM? _____

TO DRILL:
 SUBMIT FIVE (5) COPIES OF OG - 1, \$100.00 PERMIT FEE, PERFORMANCE BOND AND PERMANENT COPY OF PLAT.

TO DRILL DEEPER OR REDRILL:
 SUBMIT FIVE (5) COPIES OF OG - 1, SHOWING ORIGINAL PERMIT NUMBER AND PERFORMANCE BOND. ON WELLS DRILLED PRIOR TO 1929, A PERMANENT COPY OF THE PLAT AND THE ORIGINAL WELL RECORD MUST ALSO BE SUBMITTED.

TO FRACTURE - STIMULATE:
 OIL AND/OR GAS WELL ORIGINALLY DRILLED BEFORE JUNE 5, 1929, FIVE (5) COPIES OG - 1, PERFORMANCE BOND, PERMANENT PLAT AND ORIGINAL WELL RECORD.
 OIL AND/OR GAS WELL ORIGINALLY DRILLED ON AND/OR AFTER JUNE 5, 1929, FIVE COPIES OG - 1, SHOWING ORIGINAL PERMIT NUMBER, AND PERFORMANCE BOND.

Required forms must be filed within ninety (90) days of completion for bond release. Inspector to be notified twenty-four (24) hours in advance.

The following waiver must be completed by the coal operator if the permit is to be issued within ten days of receipt thereof.

WAIVER: I the undersigned, Agent for _____ Coal Company, Owner or Operator of the coal under this lease have examined and place on our mine maps this proposed well location.

We the _____ Coal Company have no objections to said well being drilled at this location, providing operator has complied with all rules and regulations in Articles 4, 5, and 7, Chapter 22 of the West Virginia Code.

For Coal Company

Official Title