

Latitude 39° 25'

Longitude 81° 05'

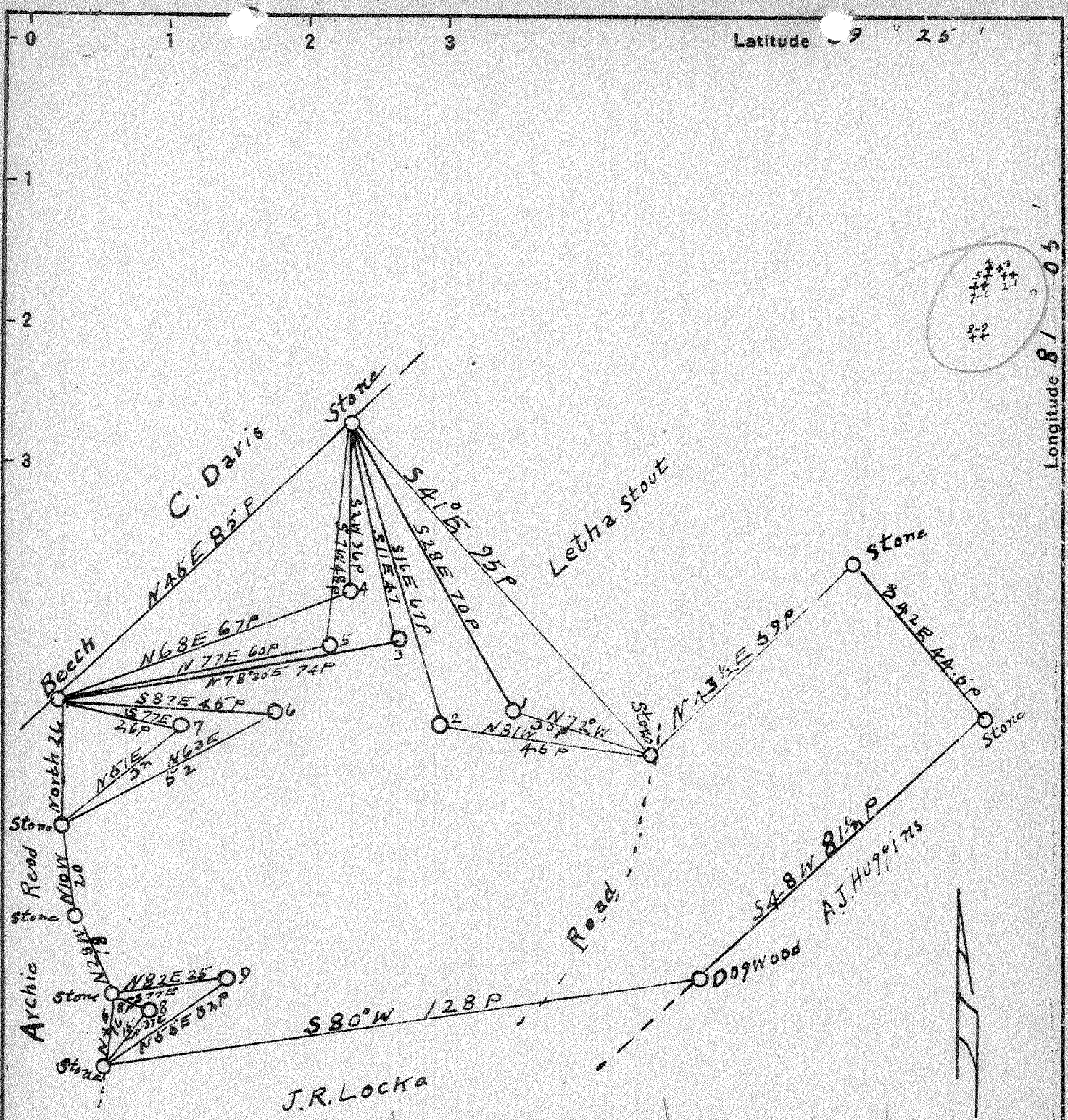

#1	0.35 W 1.83 Q	#4	0.5 W 1.8 Q	#7	0.64 W 1.93 Q
#2	0.42 W 1.83 Q	#5	0.53 W 1.96 Q	#8	0.65 W 2.31 Q
#3	0.44 W 1.92 Q	#6	0.57 W 1.92 Q	#9	0.59 W 2.3 Q

New Location   
 Drill Deeper   
 Abandonment

Company Piersol Smith & Coss  
 Address R.F.D. near Walker WVA.  
 Farm T.E. Fleming  
 Tract \_\_\_\_\_ Acres 87.6 Lease No. \_\_\_\_\_  
 Well (Farm) No. 1 to 9 Serial No. \_\_\_\_\_  
 Elevation (Spirit Level) 1/885 2/895 3/910 4/942 5/925 6/1002 7/950 8/725  
 Quadrangle St Marys  
 County Pleasants District Lafayette  
 Engineer J.E. Anderson  
 Engineer's Registration No. Wood Co. Surveyor  
 File No. \_\_\_\_\_ Drawing No. \_\_\_\_\_  
 Date 1-6-1942 Scale 1 in = 20 P

STATE OF WEST VIRGINIA 199-A-#  
 DEPARTMENT OF MINES 190-A-#  
 OIL AND GAS DIVISION 200-A-#  
 CHARLESTON 201-A-#  
 202-A-#  
 203-A-#

**WELL LOCATION MAP**  
 FILE NO. PLEAS-182-A-#8  
PLEAS-183-A-#9  
PLEAS-188-A-#5  
 + Denotes location of well on United States Topographic Maps, scale 1 to 62,500, latitude and longitude lines being represented by border lines as shown.  
 - Denotes one inch spaces on border line of original tracing.

201

Lafayette District, Pleasants County, W. Va.

By Piersol, Smith &amp; Coon, R.F. D. No. 2, Walker, W. Va.

Abandoned under permit Pleas-.....-41

On 57.5 acres, on Shawnee Run.

Elevation, 910' L.

Surface owned by T. H. Fleming, St. Marys, W. Va., and minerals by  
J. R. Locke, St. Marys, W. Va.

Drilling completed about 1900.

8" casing, 200'; 6 $\frac{1}{2}$ " 850'; all left in.

Oil well. Abandonment reported to Dept. of Mines Oct. 7, 1942.

Record to RCF from Mrs. Griffith Dec. 19, 1942.

	Top.	Bottom.
Clay and red rock	0	- 765
Cave	765	- 850
Slate and shale	850	- 885
Cow Run sand	885	- 910
Total depth		910

STATE OF WEST VIRGINIA  
DEPARTMENT OF MINES  
OIL AND GAS DIVISION

103

WELL RECORD

Permit No. ~~none~~

Oil or Gas Well  
(KIND)

Company Pierson, Smith & Coss  
 Address R. F. D No. 2, Walker, W. VA.  
 Farm T. B. Fleming Acres 87.5  
 Location (waters) Shawnee Run  
 Well No. 3 Elev. 910  
 District Lafayette County Pleasants  
 The surface of tract is owned in fee by T. B. Fleming  
 Address St Marys  
 Mineral rights are owned by J. R. Locke  
 Address St Marys, W. VA.  
 Drilling commenced about 1900  
 Drilling completed no record  
 Date Shot From To  
 With

Casing and Tubing	Used in Drilling	Left in Well	Packers
Size			Kind of Packer
16			
13			
10			Size of
8 1/4	8	200	200
6 3/4	6-1/4	850	850
5 3/16			Depth set
3			Perf. top
2			Perf. bottom
Liners Used			Perf. top
			Perf. bottom

Open Flow /10ths Water in Inch  
 /10ths Merc. in Inch  
 Volume Cu. Ft.  
 Rock Pressure lbs hrs.  
 Oil bbls., 1st 24 hrs.  
 Fresh water feet feet  
 Salt water feet feet

CASING CEMENTED SIZE No. Ft. Date  
 COAL WAS ENCOUNTERED AT FEET INCHES  
 FEET INCHES FEET INCHES  
 FEET INCHES FEET INCHES

Formation	Color	Hard or Soft	Top	Bottom	Oil, Gas or Water	Depth Found	Remarks
Clay & rock	red		0000	765			
Cave			765	850			
Slate & shale			850	885			
Cow Run	sand		885	910			

