

- New Location
- Drill Deeper
- Abandonment

Company UNITED FUEL GAS CO.
 Address CHARLESTON, W.VA.
 Farm T.M. LARCH
 Tract _____ Acres 50 Lease No. 1932
 Well (Farm) No. 5 Serial No. 3046
 Elevation (Spirit Level) 954.
 Quadrangle WALTON
 County ROANE District WALTON
 Engineer J.H. Moore
 Engineer's Registration No. 662
 File No. 72-77 Drawing No. _____
 Date 3-14-49 Scale 1" = 400'

STATE OF WEST VIRGINIA
 DEPARTMENT OF MINES
 OIL AND GAS DIVISION
 CHARLESTON
See microfilm for Well Record
WELL LOCATION MAP
 FILE NO. ROA-624-A

- + Denotes location of well on United States Topographic Maps, scale 1 to 62,500, latitude and longitude lines being represented by border lines as shown.
- Denotes one inch spaces on border line of original tracing.

O&G Div. An. Rpt 1949, Table 6
 Roane 624A comp 1913 oil well TD 2031

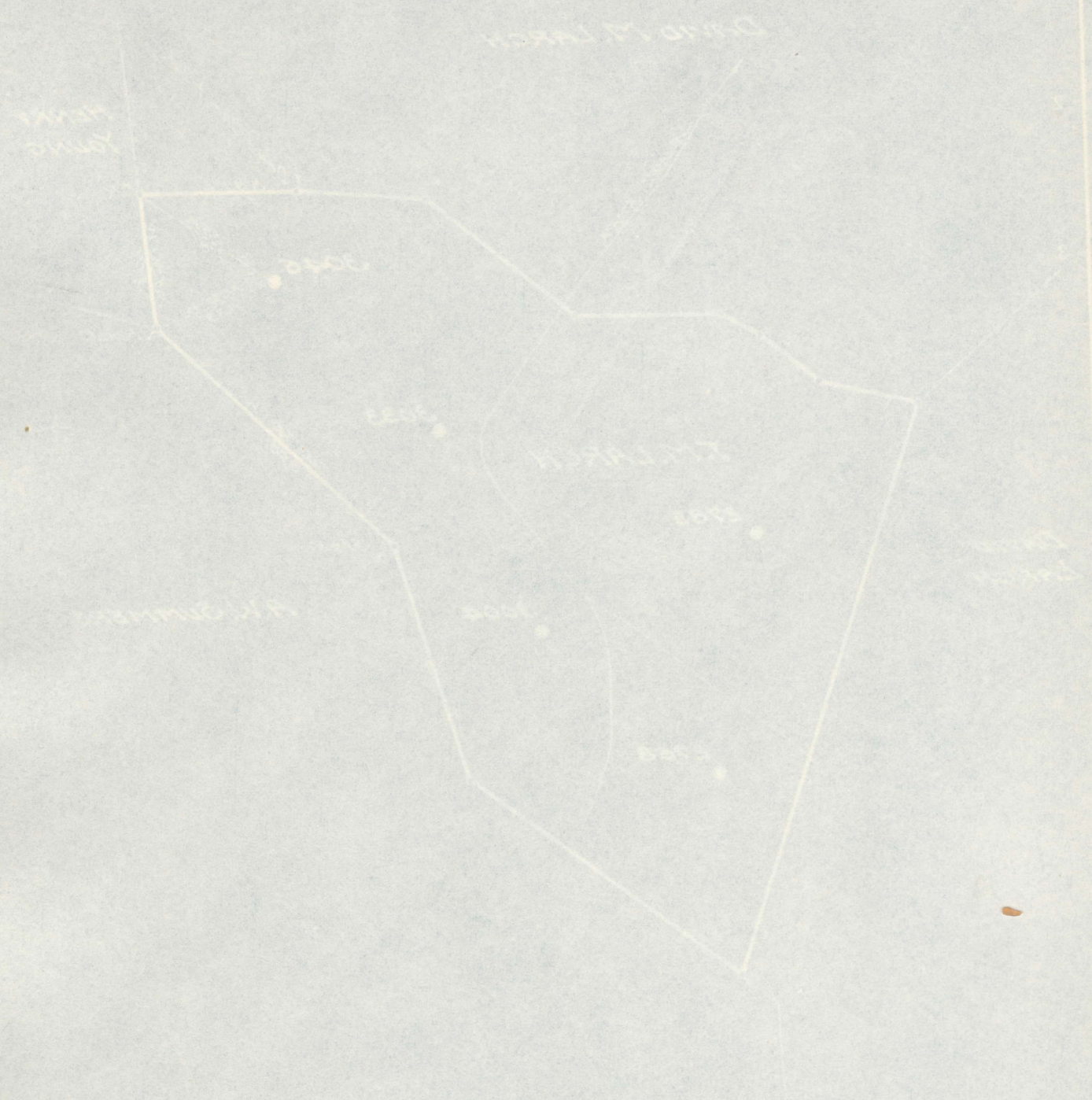

STATE OF WEST VIRGINIA
 DEPARTMENT OF MINES
 OIL AND GAS DIVISION
 CHARLESTON

WELL LOCATION MAP
 File No. ROA 624-A

+ Denotes location of well on United States
 Topographic Map, scale 1 to 62,500, feet
 Elevation and height above sea level
 by border lines as shown.

Denotes one inch square of border line
 of original location.

UNITED FUEL GAS CO
 CHARLESTON WVA
 TILLARICH
 Lease No. 1932
 Serial No. 3040
 304
 WALTON
 ROANE DISTRICT WALTON

6-6 (196)