

I, the undersigned, hereby certify that this plat is correct to the best of my knowledge and belief and shows all the information required by law and the regulations issued and prescribed by the Department of Environmental Protection.

Ben R. Singleton

P.S. 2092

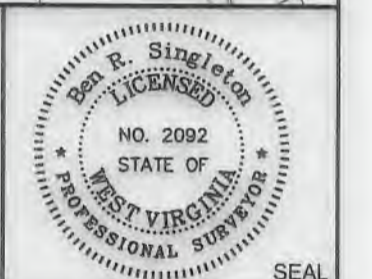

FILE NO: 289-16
 DRAWING NO: Prine 11H
 SCALE: 1" = 2000'
 MINIMUM DEGREE OF ACCURACY: 1:2500
 PROVEN SOURCE OF ELEVATION: NGS CORS Station

STATE OF WEST VIRGINIA
 DEPARTMENT OF ENVIRONMENTAL PROTECTION
 OIL AND GAS DIVISION

DATE: January 25 20 21
 OPERATOR'S WELL NO.: Prine 11H
 API WELL NO
 47 - 103 - 03359
 STATE COUNTY PERMIT

WELL TYPE: OIL GAS LIQUID INJECTION WASTE DISPOSAL
 (IF GAS) PRODUCTION: STORAGE DEEP SHALLOW
 LOCATION: ELEVATION: 1335' WATERSHED Tributary of Bear Run QUADRANGLE: Littleton
 DISTRICT: Center COUNTY: Wetzel
 SURFACE OWNER: Howard M. Henderson ACREAGE: 112
 ROYALTY OWNER: Jamie Joe Prine, et al LEASE NO: 870370 ACREAGE: 111
 PROPOSED WORK: DRILL CONVERT DRILL DEEPER FRACTURE OR STIMULATE PLUG OFF OLD FORMATION
 PERFORATE NEW FORMATION OTHER PHYSICAL CHANGE IN WELL (SPECIFY)
 PLUG AND ABANDON CLEAN OUT AND REPLUG TARGET FORMATION: Marcellus ESTIMATED DEPTH: 7,489'

WELL OPERATOR: EQT Production Company DESIGNATED AGENT: Joseph C. Mallow
 ADDRESS: 400 Woodcliff Drive ADDRESS: 115 Professional Place PO Box 280
 Canonsburg, PA 15317 Bridgeport, WV 26330

**Prine 11H
LIT53
EQT Production Company**

Tract I.D.	Tax Map No.	Parcel No.	County	District	Surface Tract Owner	Acres
1	8	43	Wetzel	Center	Howard M. Henderson	112.00
2	8	44	Wetzel	Center	William D. Henderson	65.00
3	8	45	Wetzel	Center	Howard Henderson	5.50
4	8	51.1	Wetzel	Center	Howard Henderson	18.43
5	8	53	Wetzel	Center	Ashley Murphy, et al.	20.38
6	8	31	Wetzel	Center	Howard Henderson	84.78
7	8	29	Wetzel	Center	Howard M. & William D. Henderson	57.00
8	8	28	Wetzel	Center	Matthew J. Rice	108.00
9	8	11	Wetzel	Center	Howard M. Henderson	91.50
10	8	8	Wetzel	Center	Lillian M. Pilzer & Jason L. Wright	57.00
11	8	7	Wetzel	Center	EQT Production Company	150.00
12	8	3.1	Wetzel	Center	Ballison Lumber Inc.	15.66
13	8	2	Wetzel	Center	EQT Production Company	72.43
14	5	24	Wetzel	Center	EQT Production Company	12.50
15	8	1	Wetzel	Center	EQT Production Company	81.50
16	5	15	Wetzel	Center	Howard M. Henderson	228.00
17	5	23	Wetzel	Center	Robert Long, et al.	172.50
18	11	9	Wetzel	Center	Howard M. Henderson	10.10
19	11	8	Wetzel	Center	James B. & Margie L. Montgomery	52.00
20	11	6.1	Wetzel	Center	Larry L. & Lois J. Deem	94.50
21	11	6	Wetzel	Center	Ray S. & Timmy R. Sepp	60.50
22	11	6.2	Wetzel	Center	Roger L. & Sandra K. Wade	4.00
23	8	42	Wetzel	Center	Jeffrey P. & Howard M. Henderson	67.00
24	8	55	Wetzel	Center	Ashley Murphy, et al.	9.43
25	8	47	Wetzel	Center	Howard M. Henderson	14.75
26	8	46	Wetzel	Center	Howard M. Henderson	13.20
27	8	52	Wetzel	Center	Ashley Murphy, et al.	3.35
28	8	31	Wetzel	Clay	Howard M. Henderson	8.20
29	8	59	Wetzel	Center	Ashley Murphy, et al.	47.25
30	8	30	Wetzel	Center	Howard M. Henderson	18.00
31	8	24	Wetzel	Center	Charles P. & Franny P. Wade	19.44
32	8	27	Wetzel	Center	Evan H. & Janet L. Backinger	1.80
33	8	12	Wetzel	Center	Howard Henderson	42.65
34	8	13	Wetzel	Center	Howard M. Henderson	9.50
35	8	14	Wetzel	Center	Howard M. Henderson	9.50
36	8	5	Wetzel	Center	Howard Henderson	58.00
37	8	8	Wetzel	Center	Howard M. Henderson	60.23
38	8	26	Wetzel	Center	Evan H. & Janet L. Backinger	0.25
39	8	25	Wetzel	Center	Evan H. & Janet L. Backinger	0.44
40	8	17	Wetzel	Center	Evan H. & Janet L. Backinger	91.00
41	8	10	Wetzel	Center	Howard M. Henderson	100 x 250
42	8	3	Wetzel	Center	Howard M. Henderson	38.00
43	8	16	Wetzel	Center	Evan H. & Janet L. Backinger	79.30
44	8	36	Wetzel	Center	Kenneth J. Hollibaugh	87.00
45	8	6	Wetzel	Center	David Wood	44.00
46	5	26	Wetzel	Center	Howard M. Henderson	125.14
47	5	27	Wetzel	Center	Howard M. Henderson	8.00
48	5	28	Wetzel	Center	Terry L. Riter	182.00
49	5	18	Wetzel	Center	Jack A. & Laura A. Cartwright	37.80
50	5	6	Wetzel	Center	None	None
51	5	5	Wetzel	Center	William E. & William J. Renner	5.10
52	5	4	Wetzel	Center	William E. Renner	149.54
53	5	14	Wetzel	Center	Benjamin E. Yarbse	224.00
54	5	22	Wetzel	Center	Mike Ross Inc	103.75

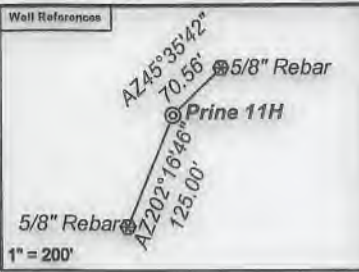

Notes:
 Prine 11H coordinates are
 NAD 27 N: 427,885.94 E: 1,697,694.98
 NAD 83 UTM N: 4,391,208.78 E: 536,559.50
 Prine 11H Landing Point coordinates are
 NAD 27 N: 430,095.90 E: 1,699,472.29
 NAD 27 Lat: 39.675957 Long: -80.567719
 NAD 83 UTM N: 4,391,891.13 E: 537,089.77
 Prine 11H Bottom Hole coordinates are
 NAD 27 N: 438,411.21 E: 1,691,156.98
 NAD 27 Lat: 39.698510 Long: -80.597620
 NAD 83 UTM N: 4,394,382.09 E: 534,514.17
 West Virginia Coordinate system of 1927 (North Zone)
 based upon Differential GPS Measurements.
 Plat orientation, corner and well ties are based upon
 the grid north meridian.
 Well location references are based upon the grid north
 meridian.
 UTM coordinates are NAD83, Zone 17, Meters.

Lease No.	Owner	Acres
870415	Howard Henderson, et al.	189
870525	Nancy E. Jolliffe, et al.	5.5
870424	Nancy E. Jolliffe	26
871343	Thomas J. Iacaboni, et al.	4.75
1028831	AMP Fund III, LP, et al.	132.6
870258	Glen E. Burnette, Jr., et al.	59
870417	Sherry Lynn Cheffen, et al.	108
870244	Howard Henderson, et al.	91.5
870188	Carol Louise Saunik Eltringham	57
870035	Stone Hill Minerals Holdings, LLC, et al.	150
1041918	Ronald R. Reiter, et al.	26.89
1046873	Coastal Forest Resources Company	15.66
877947	EQT Production Company, et al.	222
870368	Sandra Estes, et al.	81.5 & 12.5 of 288.54
870648	Delorse A. Horner, et al.	226
871183	Oakey Ray Long & Joyce Lee Long, et al.	172.5
870431	Lisa Koon, et al.	47.25

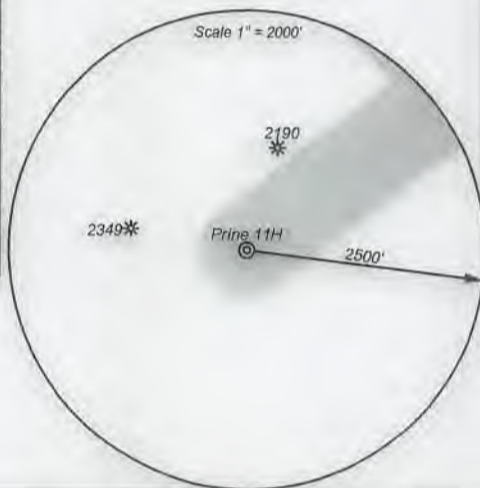
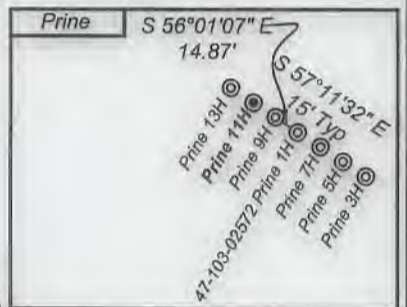

- ⊙ Proposed Gas Well
- Located Corner, as noted
- Surface Tract Lines
- Reference Line
- Lease Boundary
- Creek or Drain
- ⊙ WV County Route
- ⊙ WV State Route



I, the undersigned, hereby certify that this plat is correct to the best of my knowledge and belief and shows all the information required by law and the regulations issued and prescribed by the Department of Environmental Protection.

Ben R. Singleton
 P.S. 2092



SEAL

FILE NO: 289-16
 DRAWING NO: Prine 11H
 SCALE: 1" = 2000'
 MINIMUM DEGREE OF ACCURACY: 1:2500
 PROVEN SOURCE OF ELEVATION: NGS CORS Station



DATE: January 25 20 21
 OPERATOR'S WELL NO.: Prine 11H
 API WELL NO
 47 - 103 - 03359
 STATE COUNTY PERMIT

WELL TYPE: OIL GAS LIQUID INJECTION WASTE DISPOSAL
 (IF GAS) PRODUCTION: STORAGE DEEP SHALLOW
 LOCATION: ELEVATION: 1335' WATERSHED Tributary of Bear Run QUADRANGLE: Littleton
 DISTRICT: Center COUNTY: Wetzel
 SURFACE OWNER: Howard M. Henderson ACREAGE: 112
 ROYALTY OWNER: Jamie Joe Prine, et al LEASE NO: 870370 ACREAGE: 111
 PROPOSED WORK: DRILL CONVERT DRILL DEEPER FRACTURE OR STIMULATE PLUG OFF OLD FORMATION
 PERFORATE NEW FORMATION OTHER PHYSICAL CHANGE IN WELL (SPECIFY)
 PLUG AND ABANDON CLEAN OUT AND REPLUG TARGET FORMATION: Marcellus ESTIMATED DEPTH: 7,489'

WELL OPERATOR: EQT Production Company DESIGNATED AGENT: Joseph C. Mallow
 ADDRESS: 400 Woodcliff Drive ADDRESS: 115 Professional Place PO Box 280
 Canonsburg, PA 15317 Bridgeport, WV 26330