

- ⊙ Proposed Gas Well
- ⊙ Located Corner, as noted
- Surface Tract Lines
- Reference Line
- Lease Boundary
- Creek or Drain
- ⊙ WV County Route
- ⊙ WV State Route

(⊙) Denotes Location of Well on United States Topographic Maps



I, the undersigned, hereby certify that this plat is correct to the best of my knowledge and belief and shows all the information required by law and the regulations issued and prescribed by the Department of Environmental Protection.

Ben R. Sholtz
P.S. 2092

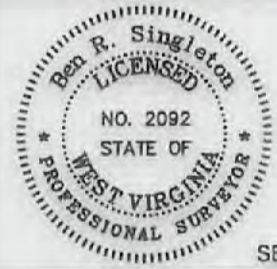

SEAL

FILE NO: 246-18
DRAWING NO: BIG245 104H
SCALE: 1" = 2000'
MINIMUM DEGREE OF ACCURACY: 1:2500
PROVEN SOURCE OF ELEVATION: NGS CORS Station

STATE OF WEST VIRGINIA
DEPARTMENT OF ENVIRONMENTAL PROTECTION
OIL AND GAS DIVISION

DATE: February 11 20 22
OPERATOR'S WELL NO.: BIG245 104H
API WELL NO MOD
47 - 103 - 03441
STATE COUNTY PERMIT

WELL TYPE: OIL GAS LIQUID INJECTION WASTE DISPOSAL
(IF GAS) PRODUCTION: STORAGE DEEP SHALLOW
LOCATION: ELEVATION: 1430' WATERSHED Rockcamp Run of Willey Fork QUADRANGLE: Big Run
DISTRICT: Grant COUNTY: Wetzel
SURFACE OWNER: ET Blue Grass LLC ACREAGE: 130.93
ROYALTY OWNER: Shiben Estates, Inc., et al. LEASE NO: 125397 ACREAGE: 140
PROPOSED WORK: DRILL CONVERT DRILL DEEPER FRACTURE OR STIMULATE PLUG OFF OLD FORMATION
 PERFORATE NEW FORMATION OTHER PHYSICAL CHANGE IN WELL (SPECIFY) _____
 PLUG AND ABANDON CLEAN OUT AND REPLUG TARGET FORMATION: Marcellus ESTIMATED DEPTH: 7,549'

WELL OPERATOR: EQT Production Company DESIGNATED AGENT: Joseph C. Mallow
ADDRESS: 400 Woodcliff Drive ADDRESS: 427 Midstate Drive
Canonsburg, PA 15317 Clarksburg, WV 26301

03/04/2022

BIG245 104H
BIG245
EQT Production Company

Tract I.D.	Tax Map No.	Parcel No.	County	District	Surface Tract Owner	Acres
1	8	22	Wetzel	Grant	ET Blue Grass LLC	138.93
2	8	21	Wetzel	Grant	Ray Joe Willey	78.27
3	8	24	Wetzel	Grant	H. Don Higginbotham	7.10
4	8	20	Wetzel	Grant	H. Don Higginbotham	23.02
5	8	53	Wetzel	Grant	H. Don Higginbotham	108.21
6	13	17	Wetzel	Grant	Mary Higginbotham	112.00
7	13	9	Wetzel	Grant	Mary Higginbotham	30.35
8	8	15	Wetzel	Grant	Utt Neal	51.08
9	8	13.1	Wetzel	Grant	Duane M. Goodrich	3.58
10	8	7	Wetzel	Grant	James E. & Martin A. Stonelung	19.12
11	8	8	Wetzel	Grant	Wanda L. Byard	50.16
12	8	15	Wetzel	Grant	John Michael Byard	71.00
13	8	22	Wetzel	Grant	James A. Yoho	17.80
14	8	20	Wetzel	Grant	Mary Jane Byard	15.06
15	8	25	Wetzel	Grant	James A. Yoho	61.00
16	8	25	Wetzel	Grant	James A. Yoho	8.25
17	8	26	Wetzel	Grant	James A. Yoho	23.25
18	8	31	Wetzel	Grant	James A. Yoho	3.00
19	8	30	Wetzel	Grant	James A. Yoho	7.80
20	8	11	Wetzel	Grant	Bonnie M. Herkane	80.50
21	8	20	Wetzel	Grant	Dale K. Dulaney, et al.	70.81
22	8	38	Wetzel	Grant	Cele K. & Sherry L. Dulaney	26.82
23	8	48	Wetzel	Grant	Donald J. Dulaney	8.85
24	8	48	Wetzel	Grant	Donald J. Dulaney	1.00
25	8	51.2	Wetzel	Grant	Gerald D. Wilke, et al.	2.82
26	8	51.1	Wetzel	Grant	Henry E. Willey	0.18
27	8	52	Wetzel	Grant	Henry E. Willey	0.26
28	8	59.1	Wetzel	Grant	Henry E. Willey	0.12
29	8	51	Wetzel	Grant	Henry E. Willey	2.31
30	8	55	Wetzel	Grant	Manuel L. McDiffie, et al.	9.25
31	13	7	Wetzel	Grant	Manuel L. McDiffie, et al.	51.80
32	13	8	Wetzel	Grant	Robert Dale	36.00
33	8	40	Wetzel	Grant	James A. Yoho	0.90
34	8	41	Wetzel	Grant	H. Don Higginbotham	6.45
35	8	32	Wetzel	Grant	Joe Pigg	82.80
36	8	28	Wetzel	Grant	Sharilyn Snider	55.52
37	8	54	Wetzel	Grant	Sharilyn Snider	20.00
38	14	7	Wetzel	Grant	Norman Derby	83.00
39	13	18	Wetzel	Grant	NA	6.00
40	13	27.1	Wetzel	Grant	Jeremy Collins	146.70
41	13	15	Wetzel	Grant	Robert Cow	27.75
42	13	25	Wetzel	Grant	Charles W. & Sierra R. Lemley	7.57
43	13	43	Wetzel	Grant	David Willey Life Estate	40.40
44	8	12	Wetzel	Grant	Shirley A. Tisus	41.90
45	8	12.1	Wetzel	Grant	Dale F. Sapp	10.10
46	8	10	Wetzel	Grant	Garland E. Minor	48.10
47	8	19	Wetzel	Grant	Philip Shreve	48.45
48	8	18	Wetzel	Grant	Coastal Forest Resources Company	137.80
49	8	23.1	Wetzel	Grant	James L. Dulaney	3.19
50	8	37	Wetzel	Grant	James L. & Karen Dulaney	14.10
51	8	38	Wetzel	Grant	James L. & Karen Dulaney	14.10
52	8	35	Wetzel	Grant	Deborah Fronczak	15.50

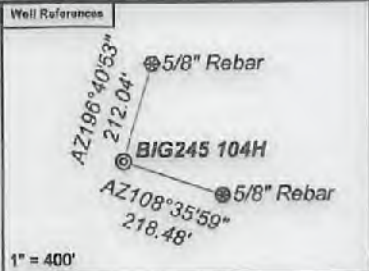

Notes:
BIG245 104H coordinates are
NAD 27 Lat: 400,708.95 E: 1,698,762.52
NAD 27 Lat: 39,595,259 Long: -80,568,928
NAD 83 UTM N: 4,382,934.52 E: 537,025.76
BIG245 104H Landing Point coordinates are
NAD 27 N: 399,466.24 E: 1,697,012.06
NAD 27 Lat: 39,591,780 Long: -80,575,157
NAD 83 UTM N: 4,382,546.89 E: 536,495.66
BIG245 104H Bottom Hole coordinates are
NAD 27 N: 393,414.77 E: 1,700,648.33
NAD 27 Lat: 39,575,295 Long: -80,562,001
NAD 83 UTM N: 4,380,721.76 E: 537,534.21
West Virginia Coordinate system of 1927 (North Zone), based upon Differential GPS Measurements. Plat orientation, corner and well ties are based upon the grid north meridian. Well location references are based upon the grid north meridian. UTM coordinates are NAD83, Zone 17, Meters.

- BIG245**
- ⊙ BIG245 114H
 - ⊙ BIG245 112H
 - ⊙ BIG245 110H
 - ⊙ BIG245 109H
 - ⊙ BIG245 106H
 - ⊙ BIG245 104H
 - ⊙ BIG245 102H
 - ⊙ 47-103-03234
 - ⊙ 47-103-03235
 - ⊙ 47-103-03236

Lease No.	Owner	Acres
102836	Shiben Estates, Inc., et al.	192
125426	Three Rivers Royalty II LLC, et al.	64
121160	Acropolis, Inc., et al.	80
125383	H. Don Higginbotham and Jane Higginbotham, et al.	26
106285	Remnants, LLC, et al.	40
125369	Bounty Minerals, LLC	10
1000109	Reda M. Amos, a/k/a Rita Mae Amos, et al.	108
125445	PA Mineral Group II, LLC	121

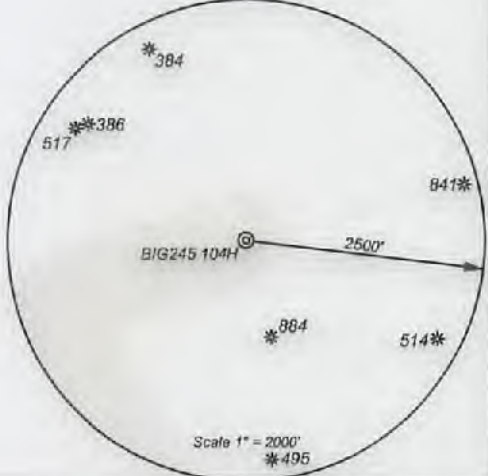

I, the undersigned, hereby certify that this plat is correct to the best of my knowledge and belief and shows all the information required by law and the regulations issued and prescribed by the Department of Environmental Protection.

Ben R. Singleton
P.S. 2092

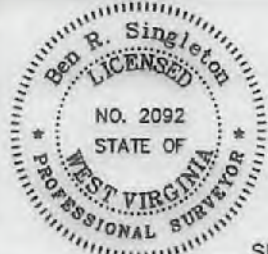

SEAL

FILE NO: 246-18
DRAWING NO: BIG245 104H
SCALE: 1" = 2000'
MINIMUM DEGREE OF ACCURACY: 1:2500
PROVEN SOURCE OF ELEVATION: NGS CORS Station

STATE OF WEST VIRGINIA
DEPARTMENT OF ENVIRONMENTAL PROTECTION
OIL AND GAS DIVISION

DATE: February 11 20 22
OPERATOR'S WELL NO.: BIG245 104H
API WELL NO MOD
47 - 103 - 03441
STATE COUNTY PERMIT

WELL TYPE: OIL GAS LIQUID INJECTION WASTE DISPOSAL
(IF GAS) PRODUCTION: STORAGE DEEP SHALLOW
LOCATION: ELEVATION: 1430' WATERSHED: Rockcamp Run of Willey Fork QUADRANGLE: Big Run
DISTRICT: Grant COUNTY: Wetzel
SURFACE OWNER: ET Blue Grass LLC ACREAGE: 138.93
ROYALTY OWNER: Shiben Estates, Inc., et al. LEASE NO: 125397 ACREAGE: 140
PROPOSED WORK: DRILL CONVERT DRILL DEEPER FRACTURE OR STIMULATE PLUG OFF OLD FORMATION
 PERFORATE NEW FORMATION OTHER PHYSICAL CHANGE IN WELL (SPECIFY)
 PLUG AND ABANDON CLEAN OUT AND REPLUG TARGET FORMATION: Marcellus ESTIMATED DEPTH: 7,549'

WELL OPERATOR: EQT Production Company DESIGNATED AGENT: Joseph C. Mallow
ADDRESS: 400 Woodcliff Drive ADDRESS: 427 Midstate Drive
Canonsburg, PA 15317 Clarksburg, WV 26301

03/04/2022