

Latitude

.57s
.59w

Longitude

Topo Location

7.5' Loc. _____ 15' Loc. _____
_____ (calc.) _____

#168 MTW Co Rept 1909

Company P+E

Farm A L Wyatt #1

15' Quad _____
(sec.)

7.5' Quad Big Run

District Grant

WELL LOCATION PLAT

County 103 Permit 70471

68A

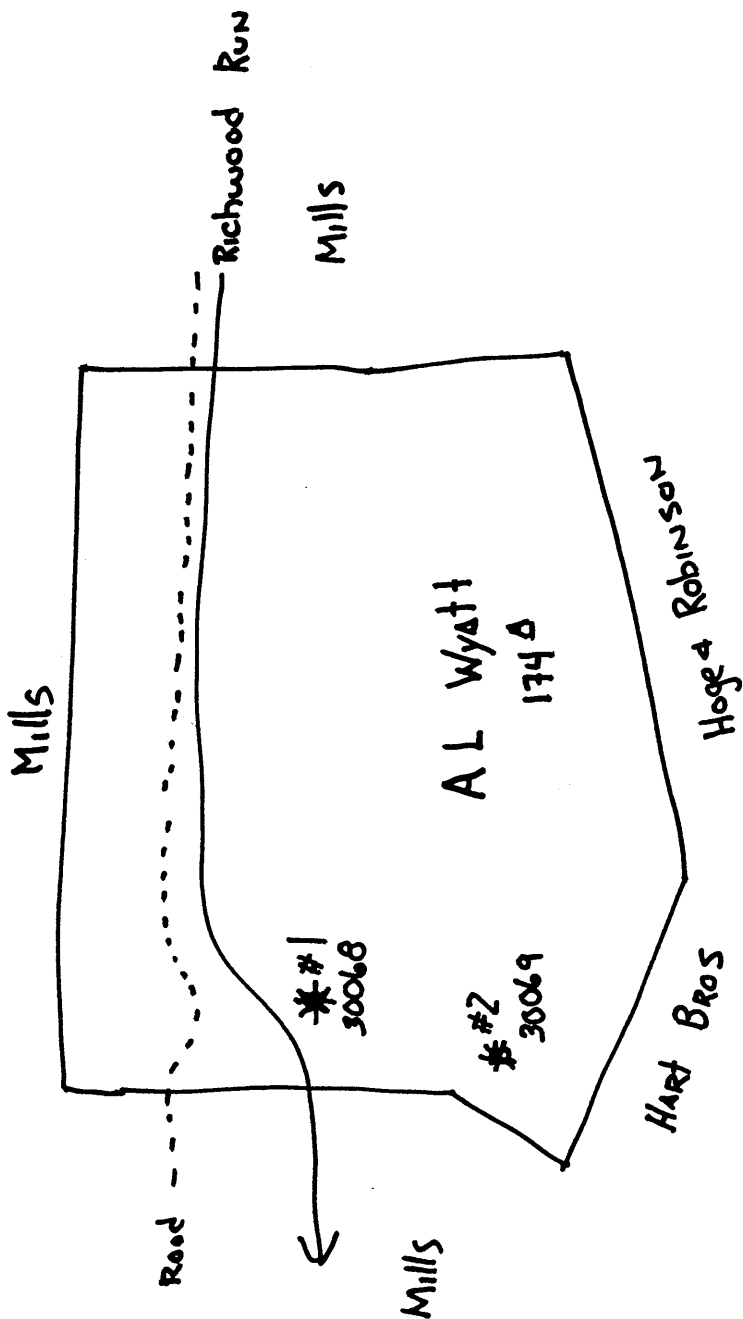

A. L. WEAFF NO. 1 WELL.

No. 678 G.F., -Wetzel.
(AS. PERMIT WET-68).

Grant District, Wetzel County, W. Va.

By The Standard Pipe & Supply Co., Marietta, Ohio. (H.H. Boren).

Abandoned under permit Wet-68.

On 17 $\frac{1}{2}$ acres, on Richwood Run; surface and minerals owned by
A. L. Wyatt, Jacksonburg, W. Va.

Elevation, 878.1' L.

16" conductor, 16"; 6 $\frac{3}{8}$ " casing, 20870'.

Coal was encountered at 685'.

Abandonment reported to Dept. of Mines Oct. 22, 1931.

Record to RCT from Mrs. Griffith Sept. 10, 1938.

	Top.	Bottom.
Pittsburgh Coal	685
Big Injun Sand	1940	- 1965 ?
Gordon Stray Sand	2720	-
Gordon Sand	2740	-
Fourth Sand	2800	-
Total depth		2920