

39° 32' 30"

Latitude

Longitude

80° 32' 30"

+
2.33s
1.68w

Topo Location

7.5' Loc. _____ 15' Loc. _____
_____ (calc.) _____

Company South Penn Oil Co
Farm Smith - Edgell #8
15' Quad _____
(sec.)
7.5' Quad Big Run
District GRANT

WELL LOCATION PLAT

County 103 Permit 30081

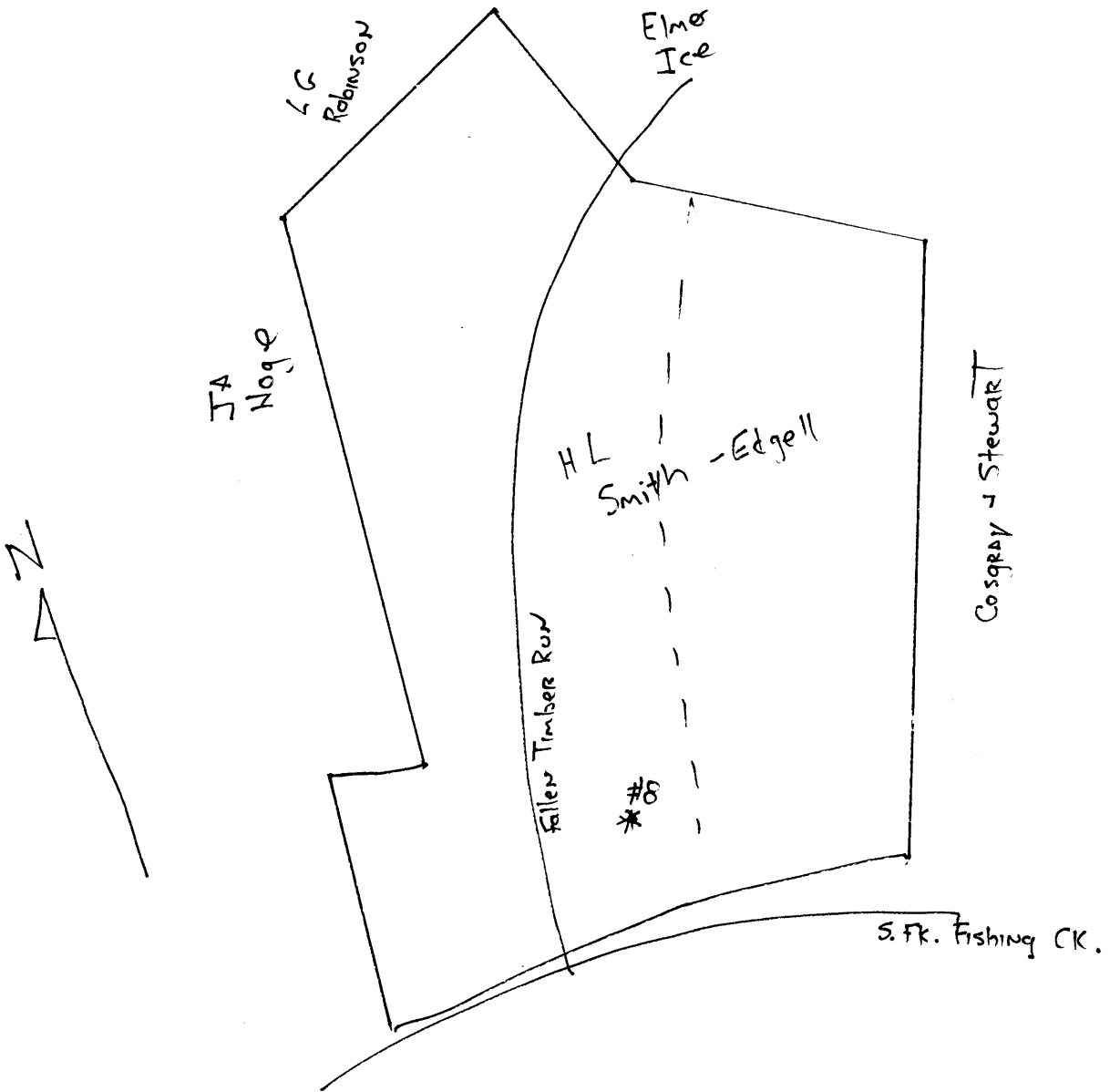

WET-81-A

Grant District, Wetzel County, W. Va.

By South Penn Oil Co., Drawer 1255, Pittsburgh, Pa.

On 352 acres, surface owned by Ezra Edgell, Smithfield, W. Va.,
and H. Laurie Smith, Trustee, 1200 E. Main St., Richmond, Va.,
and mineral rights by Cecil B. Highland et al., New Martins-
ville, W. Va.

Elevation, 1088' L.

10" casing, 160'; 8 $\frac{1}{4}$ ", 1310'; 6-5/8", 2131'; 5-3/16", 2720'.

Coal was encountered at 870'.

Liners: 4 $\frac{1}{2}$ x 4 - 306' 6" - pulled out; 4 $\frac{1}{2}$ x 4", 300'.

Abandonment reported to Dept. of Mines June 22, 1932.

Well was shot Oct. 21, 1913, with 10 qts.; at 2201', July 28,

1914, with 20 qts.; Aug. 15, 1917, at 2200', with 30 qts.;

and June 18, 1924, with 20 qts. in Gordon Sand.

Oil well.

	Top.	Bottom.
Pittsburgh Coal	870	-
Gas Sand	1474	- 1585
1st Salt Sand	1680	- 1755
2nd Salt Sand (water, 1846')	1816	- 1920
Little Lime	2072	
Big Lime	2106	- 2210?
Big Injun Sand (oil, 2200-2210')	2200?	
Total depth (first drilling)		2220
Commenced to drill deeper	2220	
Big Injun Sand (oil and water, 2280)		2365
Gantz Sand	2515	- 2525
50-Ft. Sand (5-3/16" casing, 2696')	2692	- 2720
30-Ft. Sand	2805	- 2818
Gordon Stray Sand	2912	- 2940
Gordon Sand (4 $\frac{1}{2}$ x 4" liner, 2982'; show of oil, 2992')	2982	- 3003
Shells and slate	3003	- 3337
Total depth		3337