

Latitude 39° 30'

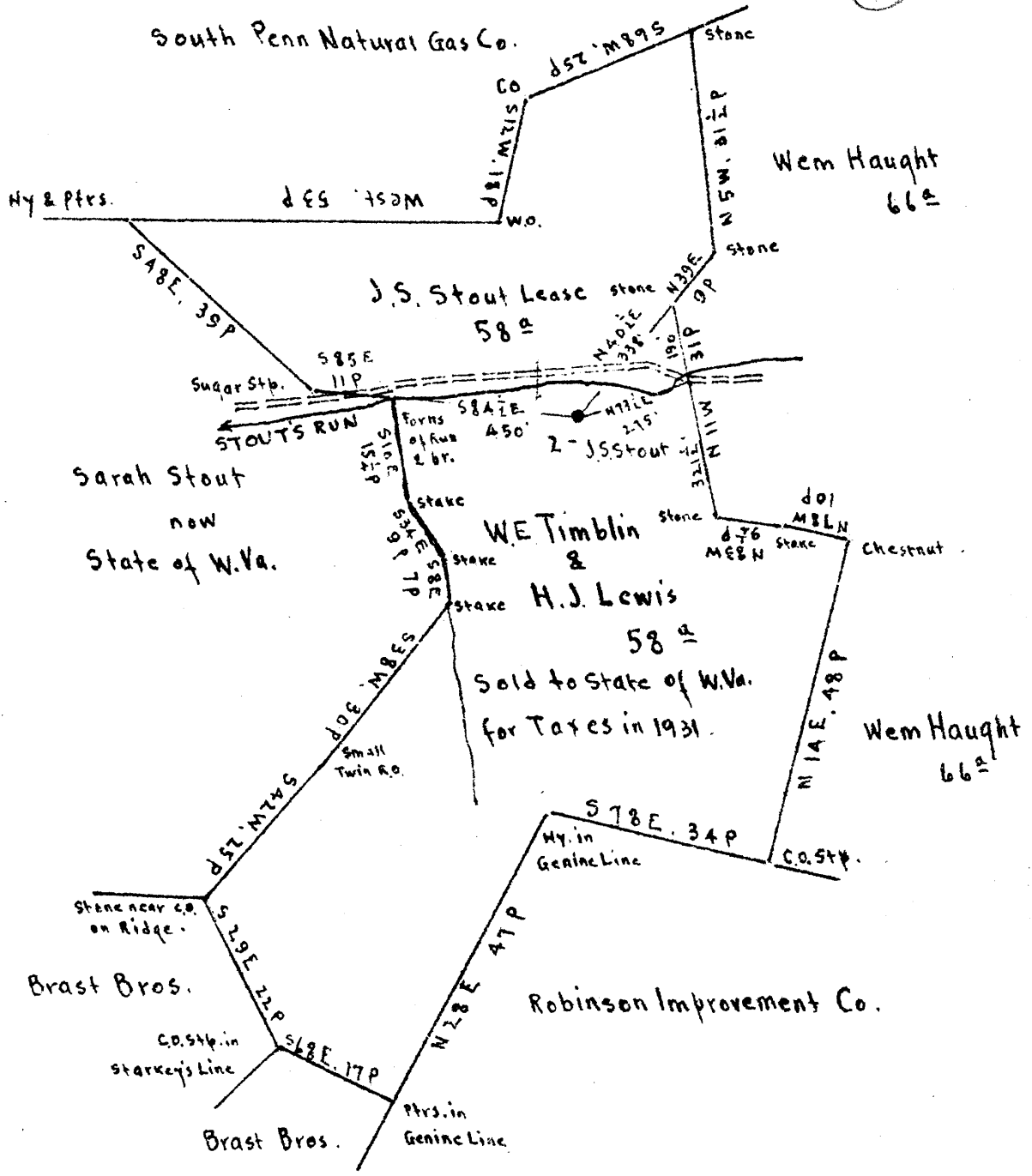

Longitude 80° 30'

Scale, 1" = 400 Feet



Surface: State of W.Va.  
 Coal: State of W.Va.

*1132 W*  
*200 57 X*

New Location   
 Drill Deeper   
 Abandonment

MAY 21 1946

Company Road Supply Co.  
 Address Salem, W.Va.  
 Farm J.S. Stout  
 Tract \_\_\_\_\_ Acres 58 Lease No. \_\_\_\_\_  
 Well (Farm) No. 2 Serial No. \_\_\_\_\_  
 Elevation (Spirit Level) \_\_\_\_\_ Floor - 1013.26  
 \_\_\_\_\_ Ground - 1012.26  
 Quadrangle GENTERPOINT  
 County Wetzel District Grant  
 Engineer E.C. Tabler  
 Engineer's Registration No. \_\_\_\_\_  
 File No. \_\_\_\_\_ Drawing No. \_\_\_\_\_  
 Date Feb. 26<sup>th</sup>, 1946 Scale 1" = 400 Feet

STATE OF WEST VIRGINIA  
 DEPARTMENT OF MINES  
 OIL AND GAS DIVISION  
 CHARLESTON

**WELL LOCATION MAP**  
 FILE NO. WET-529-A

+ Denotes location of well on United States Topographic Maps, scale 1 to 62,500, latitude and longitude lines being represented by border lines as shown.  
 - Denotes one inch spaces on border line of original tracing.





STATE OF WEST VIRGINIA  
DEPARTMENT OF MINES  
OIL AND GAS DIVISION

991

WELL RECORD

Permit No. 579-A

Oil or Gas Well X (KIND)

Company RAAD SUPPLY COMPANY  
Address 184 East Main St., Salem, W.Va.  
Farm J. S. Stout Acres 58  
Location (waters) Stouts Run  
Well No. 2 Elev. 1012.26  
District Grant County Wetzel  
The surface of tract is owned in fee by STATE OF W.VA.  
Address \_\_\_\_\_  
Mineral rights are owned by STATE OF W. VA.  
Address \_\_\_\_\_

Casing and Tubing	Used in Drilling	Left in Well	Packers
Size			
16			Kind of Packer _____
13			
10	<b>378'</b>	<b>None</b>	Size of _____
8 1/4	<b>1514'</b>	<b>None</b>	
6 5/8	<b>1816'</b>	<b>1816'</b>	Depth set _____
5 3/16	<b>2332'</b>	<b>2332'</b>	
3			Perf. top _____
2	<b>2773'</b>	<b>2773'</b>	Perf. bottom _____
Liners Used			Perf. top _____
			Perf. bottom _____

Drilling commenced \_\_\_\_\_  
Drilling completed June 17, 1898  
Date Shot ? From 2957' To 2960'  
With Shot 6 times-16-30-40-60-120&180 Qts.  
Open Flow /10ths Water in \_\_\_\_\_ Inch  
/10ths Merc. in \_\_\_\_\_ Inch  
Volume \_\_\_\_\_ Cu. Ft.  
Rock Pressure \_\_\_\_\_ lbs. \_\_\_\_\_ hrs.  
Oil \_\_\_\_\_ bbls., 1st 24 hrs.  
Fresh water \_\_\_\_\_ feet \_\_\_\_\_ feet  
Salt water \_\_\_\_\_ feet \_\_\_\_\_ feet

CASING CEMENTED No SIZE \_\_\_\_\_ No. Ft. \_\_\_\_\_ Date \_\_\_\_\_  
COAL WAS ENCOUNTERED AT 831 FEET 60 INCHES  
\_\_\_\_\_ FEET \_\_\_\_\_ INCHES FEET \_\_\_\_\_ INCHES  
\_\_\_\_\_ FEET \_\_\_\_\_ INCHES FEET \_\_\_\_\_ INCHES

Formation	Color	Hard or Soft	Top	Bottom	Oil, Gas or Water	Depth Found	Remarks
Conductor			16'				
Pittsburgh Coal			825	831'			
Dunkard Sand			1325	1350			
Salt Sand			1700	1809			
Big Lime			2036	2143			
Pencil cave			2030	2036			
Big Injun Sand			2143	2263			
Oil			2223		Oil		
Gantz Sand			2880	2900			
Fifty Foot Sand			2825	2855			
Stray Sand			2915				
Gordon Sand			2953	2965			
Gas & show oil			2918	2929	Gas, Oil		
Oil			2965		Oil		
Oil			2954	2960	Oil		
Total Depth			2973				

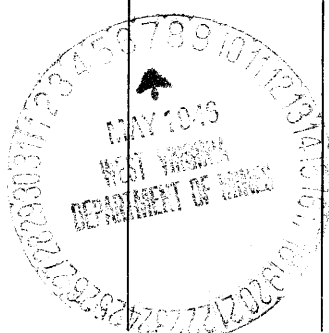

Formation	Color	Hard or Soft	Top	Bottom	Oil, Gas or Water	Depth Found	Remarks

Date May 6, 1946

APPROVED RAAD SUPPLY COMPANY, Owner

By G. M. Road  
 Manager, Owner (Title)

