

FILE NO. _____
DRAWING NO. _____
SCALE 1"=1000'
MINIMUM DEGREE OF ACCURACY 1:50000
PROVEN SOURCE OF ELEVATION GPS DISK NO. 2
ELEVATION 2130.15

I THE UNDERSIGNED, HEREBY CERTIFY THAT THIS PLAT IS CORRECT TO THE BEST OF MY KNOWLEDGE AND BELIEF AND SHOWS ALL THE INFORMATION REQUIRED BY LAW AND THE REGULATIONS ISSUED AND PRESCRIBED BY THE DEPARTMENT OF ENVIRONMENTAL PROTECTION.

(SIGNED) Bennett W. Bowman
R.P.E. _____ L.L.S. 736

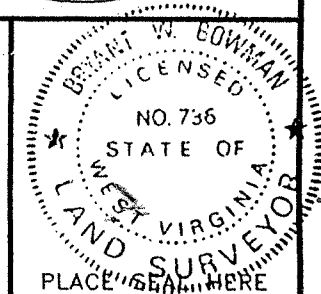

STATE OF WEST VIRGINIA
DEPARTMENT OF ENVIRONMENTAL PROTECTION
OIL AND GAS DIVISION

DATE MAY 4, 2003
OPERATOR'S WELL NO. LCHC-001B
API WELL NO. _____

WELL TYPE: OIL GAS LIQUID INJECTION WASTE DISPOSAL
(IF "GAS,") PRODUCTION STORAGE DEEP SHALLOW

LOCATION: ELEVATION 2138.27 WATERSHED CRANE FORK OF CLEAR FORK
DISTRICT OCEANA COUNTY WYOMING
QUADRANGLE PILOT KNOB, WV & MATHENY, WV

SURFACE OWNER POCOHONTAS LAND CORPORATION ACREAGE 29500±
OIL & GAS ROYALTY OWNER PENN VIRGINIA OIL & GAS CORPORATION LEASE ACREAGE 29500±
LEASE NO. _____

PROPOSED WORK: DRILL CONVERT DRILL DEEPER REDRILL FRACTURE OR STIMULATE PLUG OFF OLD FORMATION PERFORATE NEW FORMATION OTHER PHYSICAL CHANGE IN WELL (SPECIFY) _____

PLUG AND ABANDON CLEAN OUT AND REPLUG

TARGET FORMATION Lower Berkley Coals ESTIMATED DEPTH 1650'

WELL OPERATOR PENN VIRGINIA OIL & GAS CORPORATION DESIGNATED AGENT MR. HARRY JEWEL
ADDRESS 2550 EAST STONE DRIVE SUITE 110 ADDRESS PO BOX 460
KINGSPORT, TN 37660 RAVENCLIFF, WV 25913

FORM WV-6

WV 000 280 C

(McGraw 245)

MJ

State of West Virginia
Division of Environmental Production
Section of Oil and Gas

Well Operator's Report of Well Work

Farm Name Pocahontas Land Corporation

Operator Well No.: LCHC-001B

LOCATION: Elevation: 2138

Quadrangle: Pilot Knob 7 1/2'

District: Oceana County: Wyoming
Latitude: 14300 Feet South of 37 Deg. 47 Min. 30 Sec.
Longitude: 10850 Feet West of 81 Deg. 30 Min. 00 Sec.

Company:

Penn Virginia Oil & Gas Corporation

	Casing and Tubing	Used in drilling	Left in well	Cement fill up Cu. Ft.
Address: 2550 East Stone Drive, Suite 110 Kingsport, TN 37660	12 3/4"	21'	21'	0
Agent: Harry Jewell	9 5/8"	316'	316'	140
Inspector: Ronald Scott	7"	1552'	1552'	371
Date Permit Issued: 06/30/2003				
Date Well Work Commenced: 07/01/2003				
Date Well Work Completed: 10/20/2003				
Verbal Plugging:				
Date Permission granted on:				
Rotary X Cable Rig				
Total Depth (feet): 1,642				
Fresh Water Depth (ft):				
Salt Water Depth (ft):				
Is coal being mined in area (N/Y)? N				
Coal Depths (ft): 290'-296', 370'-374', 520'-522', 1060'-1062', 1588'-1591'				

RECEIVED
Office of Oil & Gas

JAN 30 2004

WV Department of
Environmental Protection

OPEN FLOW DATA

Producing formation Lower Beckley Coals Pay zone depth (ft) _____

Gas: Initial open flow 500 MCF/d Oil: Initial open flow _____ Bbl/d
 Final open flow _____ MCF/d Final open flow _____ Bbl/d
 Time of open flow between initial and final tests: _____ Hours
 Static rock pressure _____ psig (surface pressure) after _____ Hours

Second producing formation _____ Pay zone depth (ft) _____

Gas: Initial open flow _____ MCF/d Oil: Initial open flow _____ Bbl/d
 Final open flow _____ MCF/d Final open flow _____ Bbl/d
 Time of open flow between initial and final tests: _____ Hours
 Static rock pressure _____ psig (surface pressure) after _____ Hours

NOTE: ON BACK OF THIS FORM PUT THE FOLLOWING: 1). DETAILS OF PERFORATED INTERVALS, FRACTURING OR STIMULATING, PHYSICAL CHANE, TEC. 2). THE WELL LOG WHICH IS A SYSTEMATIC DETAILED GEOLOGICAL RECORD OF ALL FORMATIONS, INCLUDING COAL ENCOUNTERED BY THE WELLBORE.

Signed: *Michael D. Simpson*
By: _____
Date: 1/28/2004

FEB 13 2004

Wyom. 2280 C

DETAILS OF PERFORATIONS, FRACTURING, OR PHYSICAL CHANGE, ETC.

<u>FORMATIONS</u>	<u>TOP</u>	<u>BOTTOM</u>	<u>REMARKS</u>
Sandstone & Shale	0	272	
Coal	272	277	
Sandstone & Shale	277	485	
Coal	485	488	
Sandstone & Shale	488	605	
Coal	605	607	
Sandstone & Shale	607	1587	
Lower Beckley	1587	1590.5	
Sandstone & Shale	1590.5	1599.5	
Coal	1599.5	1601.5	
Sandstone & Shale	1601.5	1639	